

NOTE: REQUIRES NARROWED GAS TANK DUE TO RELOCATED FRAME RAILS

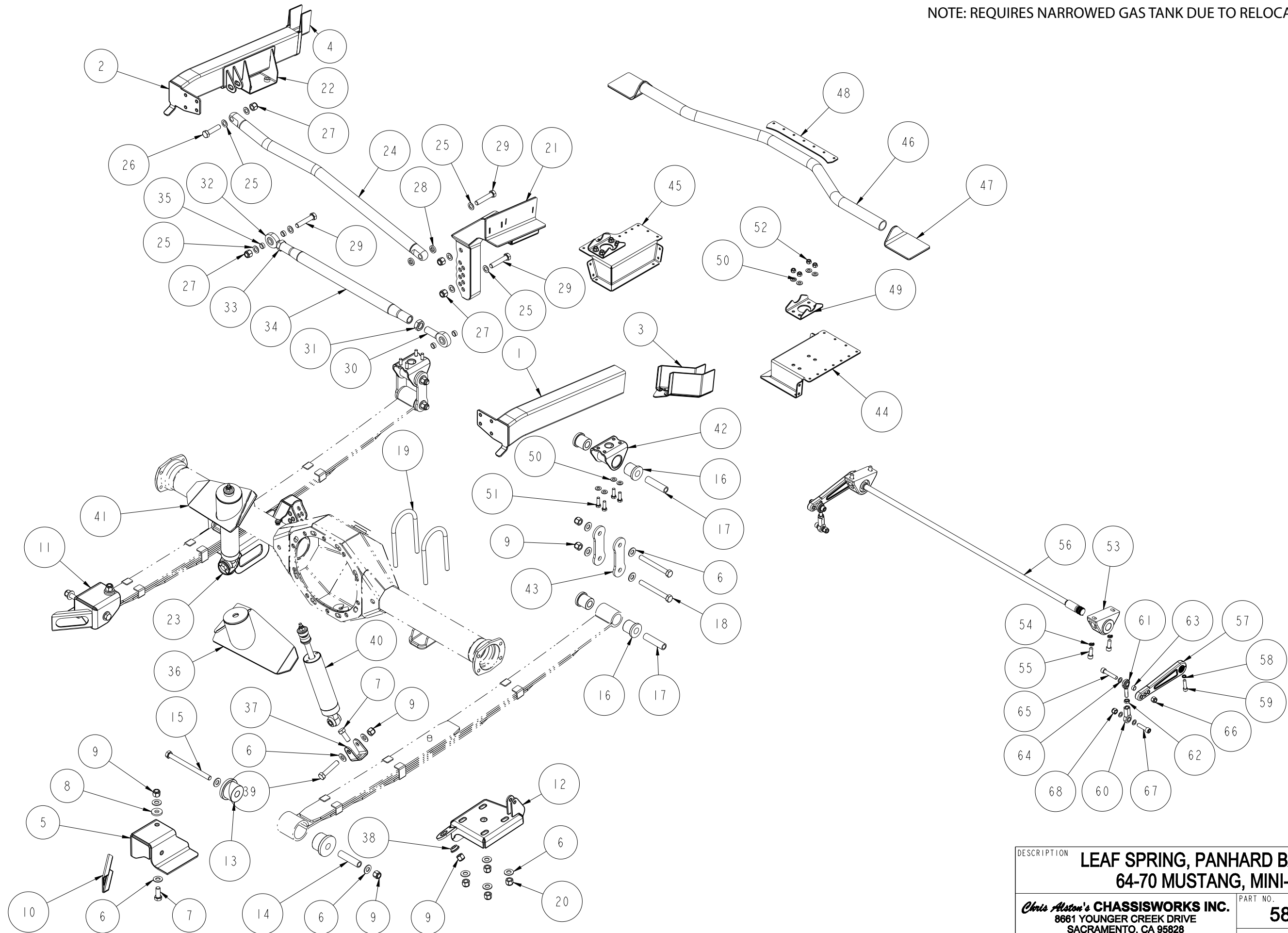

DESCRIPTION	LEAF SPRING, PANHARD BAR, ARB, 64-70 MUSTANG, MINI-TUB	
<i>Chris Alston's</i> CHASSISWORKS INC. 8661 YOUNGER CREEK DRIVE SACRAMENTO, CA 95828 (916) 388-0288 FAX 388-0295	PART NO.	5868-M10-PB
	10/16/19	DWG: 915868-M10PB

ITEM	QTY	PART NO.	DESCRIPTION
1	1	7902-057	FRAME RAIL ASSY, DRIVER, 64-70 MUSTANG, MINI-TUB
2	1	7902-060	FRAME RAIL ASSY, PASSENGER, 64-70 MUSTANG, MINI-TUB
3	1	7902-091	RAIL CAP WELDMENT, DRIVER, 64-70 MUSTANG, MINI-TUB
4	1	7902-095	RAIL CAP WELDMENT, PASSENGER, 64-70 MUSTANG, MINI-TUB
5	1	7902-069	BRACKET, LEAF SPRING, DRV, 64-70 MUSTANG, MINI-TUB
6	28	3120-050S-Y	FLAT WASHER, 1/2 SAE, HARDENED, YELLOW ZINC
7	4	3100-050C1.25Y	HEX BOLT, 1/2-13 x 1 1/4, GRADE 8, YELLOW ZINC
8	2	210136	WASHER, Ø 1 1/4 x Ø 1/2 x .180 THICK
9	12	3101-050-13C	LOCKNUT 1/2-13, GRADE 5, NYLON INSERT, CLEAR ZINC
10	2	7902-071	GUSSET, LEAF SPRING, 64-70 MUSTANG, MINI-TUB
11	1	7902-070	BRACKET, LEAF SPRING, PSGR, 64-70 MUSTANG, MINI-TUB
12	1	7902-010	REAR LEAF SPRING PLATE ASSY DRIVER, PANHARD BAR, 64-70 MUSTANG
13	4	3141-2466-1.56	POLYURETHANE BUSHING, 2.540 FLANGE x 2.050 BARREL x .750 BORE
14	2	3140-1624-099	SLEEVE, Ø 3/4 x 1/2 x 3.085
15	2	3100-050C6.50Y	HEX BOLT, 1/2-13 x 6 1/2, GRADE 8, YELLOW ZINC
16	8	3141-2445-1.50	POLYURETHANE BUSHING, 1.710 FLANGE x 1.390 BARREL x .750 BORE
17	4	3140-1624-096	SLEEVE, Ø 3/4 x 1/2 x 3.000
18	4	3100-050C4.50Y	HEX BOLT, 1/2-13 x 4 1/2, GRADE 8, YELLOW ZINC
19	4	3147-300.50-650	U-BOLT, AXLE TUBE, 1/2-20 x 3.00 x 6.50
20	8	3131-050-20Y	LOCKNUT 1/2-20, GRADE 8, NYLON INSERT, YELLOW ZINC
21	1	7902-045	ASSY, FRAME BRACKET, DRV, LEAF SPRING PANHARD BAR, 64-70 MUSTANG, MINI-TUB
22	1	7902-052	ASSY, FRAME BRACKET, PSGR, LEAF SPRING PANHARD BAR, 64-70 MUSTANG, MINI-TUB
23	1	7902-011	REAR LEAF SPRING PLATE ASSY, PSGR, PANHARD BAR, 64-70 MUSTANG
24	1	7902-055	ASSY, CROSS TUBE, LEAF SPRING PANHARD BAR, 64-70 MUSTANG, MINI-TUB
25	8	3109-050-S-2-Y	AIRCRAFT WASHER 1/2 x .062 THICK
26	1	3100-050F2.00Y	HEX BOLT, 1/2-20 x 2, GRADE 8, YELLOW ZINC
27	4	3101-050-20C	LOCKNUT, 1/2-20, GRADE 5, NYLON INSERT, CLEAR ZINC
28	2	3140-1628-006	SLEEVE, SPACER, Ø 7/8 x 1/2 x .175
29	3	3100-050F2.50Y	HEX BOLT, 1/2-20 x 2 1/2, GRADE 8, YELLOW ZINC
30	1	3112-075X050-L	ROD END, 3/4-16 LEFT x 1/2 BORE, 4130, NYLON, KMXL12-8
31	1	3102-075-16LY	JAM NUT, 3/4-16 LEFT, YELLOW ZINC
32	1	3112-075X050-R	ROD END, 3/4-16 RIGHT x 1/2 BORE, 4130, NYLON, KMX12-8
33	1	3102-075-16RC	JAM NUT, 3/4-16 RIGHT, CLEAR ZINC
34	1	7907-75-20.63-S	RADIUS ROD, 3/4-16 THREAD x 20.625 LONG, SATIN
35	4	1000	MISALIGNMENT BUSHING □n□ 1/2 BORE x .250
36	1	7902-073	SHOCK MOUNT, UPPER, DRV, 64-70 MUSTANG, MINI-TUB
37	2	7902-099	FOLDED CLEVIS 1/2 x 1.25 WIDE
38	2	7902-100	SPACER, SHOCK CLEVIS, LEAF SPRING PLATE, 64-70 MUSTANG
39	2	3100-050C2.50Y	HEX BOLT, 1/2-13 x 2 1/2, GRADE 8, YELLOW ZINC
40	2	VAS 12042-515	S/B SENISET, 63 SPOOL x STEM-B, 5.15 TRAVEL

DESCRIPTION	LEAF SPRING, PANHARD BAR, ARB, 64-70 MUSTANG, MINI-TUB	
<i>Chris Aston's</i> CHASSISWORKS INC. 8661 YOUNGER CREEK DRIVE SACRAMENTO, CA 95828 (916) 388-0288 FAX 388-0295	PART NO.	5868-M10-PB
	10/16/19	DWG: 915868-M10PB

41	1	7902-077	SHOCK MOUNT, UPPER, PSGR, 64-70 MUSTANG, MINI-TUB
42	2	7902-098	WELDMENT, HANGER, LEAF SPRING, 64-70 MUSTANG, MINI-TUB
43	4	7902-005	SHACKLE, 3 1/2 CENTERS
44	1	7902-063	TORQUE BOX, LEAF SPRING MOUNT, DRIVER, 64-70 MUSTANG, MINI-TUB
45	1	7902-064	TORQUE BOX, LEAF SPRING MOUNT, PASSENGER, 64-70 MUSTANG, MINI-TUB
46	1	7902-066	SUPPORT TUBE, SPRING MOUNT, 64-70 MUSTANG, MINI-TUB
47	2	7902-067	TUBE GUSSET, SPRING MOUNT, 64-70 MUSTANG, MINI-TUB
48	1	7902-068	REAR GUSSET, SUPPORT TUBE, 64-70 MUSTANG, MINI-TUB
49	2	7902-065	SPRING MOUNT, TORQUE BOX, 64-70 MUSTANG, MINI-TUB
50	16	3120-031S-Y	FLAT WASHER, 5/16 SAE, HARDENED, YELLOW ZINC
51	8	3100-031C1.00Y	HEX BOLT, 5/16-18 x 1, GRADE 8, YELLOW ZINC
52	8	3101-031-18C	LOCKNUT 5/16-18, GRADE 5, NYLON INSERT, CLEAR ZINC
53	2	7962-0122-088	BUSHING HOUSING ASSEMBLY, Ø7/8 BEARING
54	4	3108-038H-C	HIGH COLLAR LOCKWASHER, 3/8 STEEL, CLEAR ZINC
55	4	3103-038C1.00C	SOCKET HEAD CAP SCREW, GRADE 8, 3/8-16 x 1, CLEAR ZINC,
56	1	7953W-3769C063C	ANTI-ROLL BAR, WELDED, Ø5/8, 7/8-48 SERRATION x 37.688 LONG
57	2	7962-0155-0	ARM, ANTI-ROLL BAR, STRAIGHT, 7/8-48 SERRATIONS, IRS
58	2	3108-031H-S	HIGH COLLAR LOCKWASHER, 5/16 INCH 18-8 STAINLESS
59	2	3103-031F1.25C	SOCKET HEAD CAP SCREW, 5/16-24 x 1 1/4, CLEAR ZINC
60	2	3127-038X038-RT	ROD END 3/8 x 3/8 BORE RIGHT, FEMALE, CF6T
61	2	3111-038X038-RT	ROD END, 3/8-24 RIGHT x 3/8 BORE, MALE, TEFLON, CM6T
62	2	3102-038-24RC	JAM NUT, 3/8-24 RIGHT, CLEAR ZINC
63	2	3140-1216-008	SLEEVE, Ø1/2 x .384 x 1/4
64	6	3109-038-S-2-Y	AIRCRAFT WASHER 3/8 x .062 THICK
65	2	3103-038F2.00C	SOCKET HEAD CAP SCREW, GRADE 8, 3/8-24 x 2, CLEAR ZINC
66	2	3101-038-24C	LOCKNUT, 3/8-24, GRADE 5, NYLON INSERT, CLEAR ZINC
67	2	3103-038C1.50C	SOCKET HEAD CAP SCREW, GRADE 8, 3/8-16 x 1 1/2, CLEAR ZINC
68	2	3101-038-16C	LOCKNUT 3/8-16, GRADE 5, NYLON INSERT, CLEAR ZINC

DESCRIPTION		LEAF SPRING, PANHARD BAR, ARB, 64-70 MUSTANG, MINI-TUB	
<i>Chris Aston's</i> CHASSISWORKS INC. 8661 YOUNGER CREEK DRIVE SACRAMENTO, CA 95828 (916) 388-0288 FAX 388-0295		PART NO.	5868-M10-PB
		10/16/19	DWG: 915868-M10PB