



A Chris Alston's Chassisworks, Inc. Brand

Bolt-In Rear Shock – '79-04 Mustang

VariShock Bolt-In, Adjustable Rear Shocks for 1979-2004 Mustangs and Fox Chassis Vehicles

3/8"-Thread Stem Mount

Premium Urethane Bushings

Premium Urethane Grommet

5/8" Chrome-Steel Piston Rod

Aluminum Shock Body

QuickSet 1
Single Adjustable

Urethane
Bushing Eye

QuickSet 2
Double
Adjustable



Features

- Available in two travel lengths: 8.25" (stock) and 7.15" (lowered)
- All-aluminum design for minimum weight
- Made in America
- Urethane bushings
- Individually dyno-tested and calibrated to ensure uniform performance
- Revolutionary adjuster mechanism provides shorter body at any travel length
- Unique mounting-eye designs create greater clearance
- Urethane mounting-eye contains 3.5 times the amount of urethane material for longer life
- Rebuildable if necessary

Double-Adjustable

- Double external adjustment with 16 steps each. Adjusts both bump and rebound individually from soft to hard
- Adjuster knob is clearly laser-etched with plus and minus signs
- Bump and rebound knobs clearly marked by arrows etched in body

Single-Adjustable

- Single external adjustment with 16 steps. Adjusts both bump and rebound equally from soft to hard

Bolt-In Rear Shock – 1979-2004 Mustang

Designed from a clean sheet of paper, VariShock is the first affordable bolt-in to combine sophisticated shock valving with all-new, American-made components. Never before have so much performance, repeatability, and adjustability been offered at such an affordable price.

VariShock's single-adjustable model offers 16 settings where both bump and rebound are adjusted simultaneously. This offers a good compromise between the ultimate tunability of the QuickSet 2 and affordability of the QuickSet 1.

VariShock's double-adjustable design enables 256 different settings, attainable simply by rotating two fully accessible, 16-position knobs. All adjustments are made in seconds, without removing or unbolting the VariShock. One knob sets the bump (compression) range; the other sets rebound (extension). Knobs are laser-etched with directional arrows and "plus/minus" symbols that clearly indicate which direction achieves the desired adjustment. Additional arrows etched into the QuickSet 2's base reveal which knob sets bump and which sets rebound.

Our double-adjustable QuickSet 2 allows you to control vehicle separation (rebound) and settling (bump) independent of each other. This allows you to tune your suspension to track conditions for ultimate performance.

Repeatability is unprecedented! By controlling the quality of the components, assembling them in-house, and dyno-testing every assembly, Chris Alston's Chassisworks can deliver a pair of VariShocks that

perform virtually identically — throughout the entire range of travel. Whereas other brands in this price range rely on cheaper offshore or OEM parts, American-made VariShocks are engineered systems of premium components, all designed to meet your specific needs. The shocks use deflective disk valving in the pistons to eliminate spring fatigue. They have piston rods made from 5/8" centerless-ground hard-chrome steel for wear resistance and long service life. VariShock models are even rebuildable in the event they get bent or damaged. Custom valving is also available.

A revolutionary adjustment mechanism, smaller than any previous design, allows our billet aluminum body to be both shorter and lighter. You get more clearance around the eyes and greater travel within any shock length. Two separate eyes maximize the benefits of each mounting-eye style. The eye has more clearance around the mounting brackets than any other design. The urethane end has up to 350% more urethane material than other brands, for superior load distribution, yet no less clearance around the eye. We also chose a premium urethane that has a much higher load capacity for improved life compared with the poly bushings from other manufacturers. Urethane ends are 1-1/4" wide and accept 1/2" bolts.

Durability was improved in three areas. Internal shaft seals specifically designed and manufactured for these shock absorbers produce a longer-lasting seal that helps keep dirt out of the shock absorber. Internal connections and return paths use a unique machined configuration and added seals to prevent bypassing. During low piston speeds the damping action of the shock is dominated by bypassing flows. VariShock eliminates the bypassing of internal leakage to give the shock repeatable control even at low piston speeds.

The Truth About 16 vs. 24 Clicks

Don't be fooled by shocks offering more adjustment clicks. They are actually 1/2-click adjustments. The manufacturer merely added more detents to the mechanism without increasing the range of adjustment. This practice gives more clicks, but the adjustment is so slight that your vehicle will not respond to the change. A 16-position VariShock actually has a broader range of adjustable force with the added benefit of a more manageable number of adjustments to try.

'79-04 Mustang and Other Fox Chassis Vehicles

Part Number	Valving	Compressed Length	Extended Length	Minimum Ride Height	Maximum Ride Height	Shock Travel	Upper Mount	Lower Mount	Price
VAS 14149-715 ¹	Single	11.20	18.35	14.06	15.49	7.15	Stem 3/8	Cantilever Pin / Bushing Eye ³	\$184-ea
VAS 14149-825 ²	Single	12.30	20.55	15.60	17.25	8.25	Stem 3/8	Cantilever Pin / Bushing Eye ³	184-ea
VAS 14249-715 ¹	Double	11.20	18.35	14.06	15.49	7.15	Stem 3/8	Cantilever Pin / Bushing Eye ³	284-ea
VAS 14249-825 ²	Double	12.30	20.55	15.60	17.25	8.25	Stem 3/8	Cantilever Pin / Bushing Eye ³	284-ea

Notes:	
*	You must verify shock ride height, travel, and mountings will fit your application.
1	Shorter-length shock for lowered vehicles.
2	Stock-length replacement for factory ride-height applications.
3	Packaged hardware covers both 400 and 401 types of mounts. Some received hardware will not be used.

Hardware Information

201 Upper 3/8 thread stem x 2-1/8 long

400 Cantilever pin 1/2 thread with 1-5/16 offset

401 7/16 bolt x 1-1/4, 1-3/8, 3-3/8 sleeve width
 12-mm bolt x 1-1/4, 1-1/2, 1-5/8 sleeve width
 1/2 bolt x 1-1/4, 1-3/8, 1-5/8 sleeve width



**201/202
STEM**

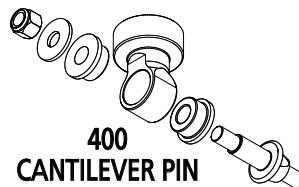

**400
CANTILEVER PIN**



**401
BUSHING EYE**

All prices subject to change. Current pricing available at www.varishock.com.



A Chris Alston's Chassisworks, Inc. Brand

VariShock
 8661 Younger Creek Drive
 Sacramento, CA 95828

Order: 800-722-2269
 Tech: 916-388-0288
 Fax: 916-388-0295

varishock@cachassisworks.com
www.varishock.com