

VariStrut Front Integral-Spindle Systems



Product system is for use with any of our strut chassis kits.

VariStrut is a new family of racing front struts designed and manufactured in the United States. The CNC-machined strut assembly incorporates all the features of our double-adjustable VariShock. It uses our 1-piece,

self-locking lower spring seat. The base is machined out of billet stainless steel to incorporate the lower body with the axle. The steering arm, lower A-arm mounting stud, and brake-caliper bracket bolt directly to the base. This compact unit allows us to drop the shock reservoir below the center of the axle. The axle does not press in, which significantly increases available travel. VariStruts are available in 4"-travel aluminum-reservoir and 6"-travel 4130-reservoir configurations. Total suspension travel is increased 60% or greater when compared to struts that offer only 2-1/2" of travel. Each strut accepts 2-1/2"-ID VariSprings with a broad range of spring rates from which to choose. VariStruts were designed as bolt-in replacements for Strange struts to increase your travel by over 1-1/2" to 3-1/2". VariStruts with extended travel are perfect for drag classes restricted to smaller tires. They provide more front suspension travel to increase weight transfer. Available with stud or eye upper mounts. The eye mount uses a spherical

bearing (COM-8 Teflon®-lined 1/2" bore x 1-1/8" wide). VariStrut offers excellent weight transfer, high-speed stability, and ease of installation for a lightweight front suspension.

Installation is eased with our 2-piece, spherical-bearing control arm. With a lower pivot on the strut, the control arm adjusts to set camber and caster. The ride height is set using our lower spring seat. The upper mount can be an 11/16" stem or a spherical COM-8 bearing. The damping is adjusted by two knobs on the lower body. Positioned away from the wheel and brake disc for easy access.

VariStrut is a double-adjustable strut with 16-step adjustments on both bump (compression) and rebound (extension). This allows for an unprecedented 256 combinations of control. The double-adjustable strut allows you to independently set how the car separates for weight transfer and how fast it settles down the track.



Save \$200!
Purchase strut package with clip or chassis



VariStrut Integral-Spindle

■ Lower Control Arms

Control arms are built from 1"-OD 4130 tubing with 1/2"-thread weld-in tube adapters. A high-misalignment, 5/8"-bore, Teflon®-lined, spherical bearing is housed in a specialized tube adapter that connects to the two arm lengths with the strut's pivot stud. Half-inch shank, Teflon®-lined, 4130 rod ends are available in two different bore sizes to match the most common chassis mounts; 7/16" or 1/2".

| CONTROL ARM ARM OPTIONS | VARISTRUT CONTROL ARMS, (PAIR INCLUDED WITH STRUT) | INCLUDED |
|-------------------------|---|------------|
| | 4130 ROD ENDS 7/16" BORE X 1/2" THREAD, SET OF FOUR | ADD 110.00 |
| | 4130 ROD ENDS 1/2" BORE X 1/2" THREAD, SET OF FOUR | ADD 110.00 |

Lower control arms are included with strut purchase, but can also be purchased separately (6191)

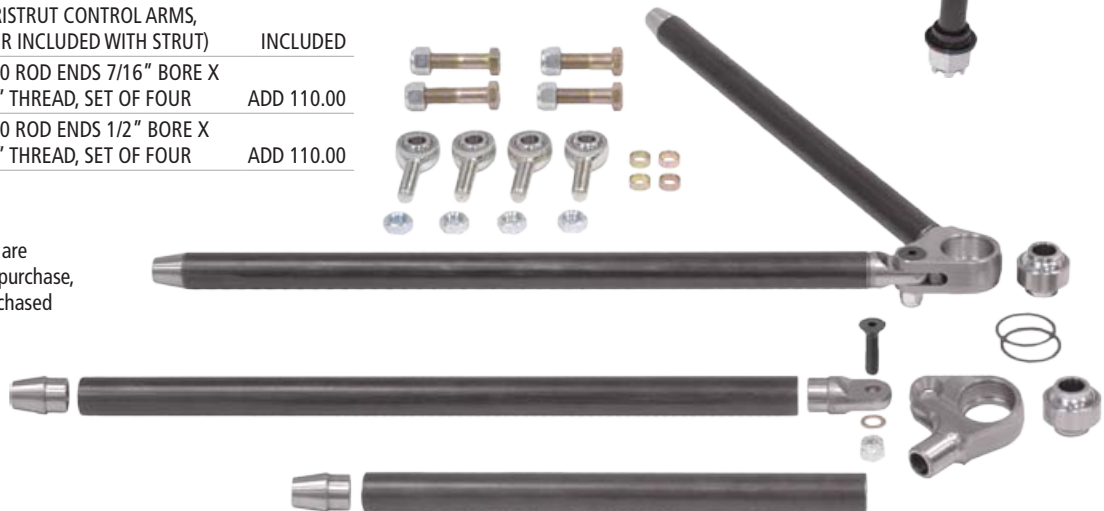

Systems Include:

- Aluminum (4" travel) or 4130 (6" travel) reservoir body with integral-spindle stainless-steel strut base
- Choice of top mount styles (stem mount only)
- QuickSet 2 double-adjustable shock valving
- Choice of spring rate
4" Strut – 210 to 400 lb/in
6" Strut – 80 to 300 lb/in
- Lower control arm components (rod ends optionally included)
- Hub- or spindle mount brake kit (various upgrade options available)

VariStrut Integral Spindle

■ Eye-Mount 4" Travel Strut

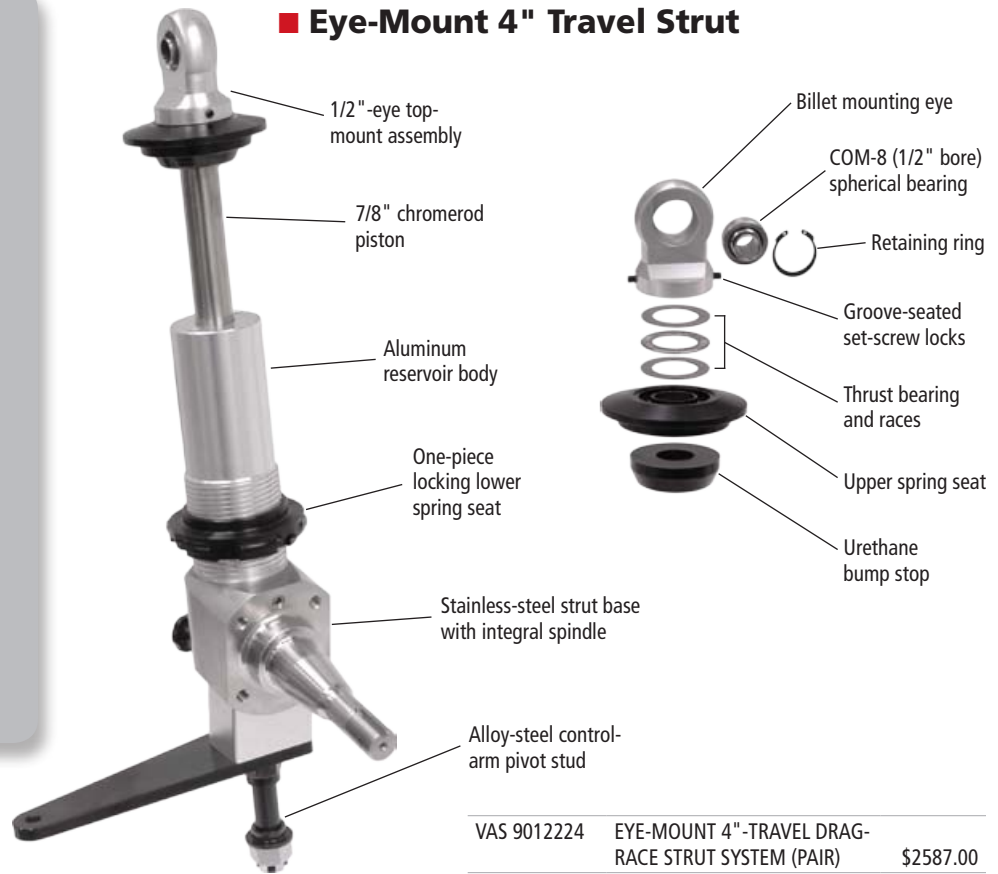

| | | |
|-------------|---|-----------|
| VAS 9012224 | EYE-MOUNT 4"-TRAVEL DRAG-RACE STRUT SYSTEM (PAIR) | \$2587.00 |
|-------------|---|-----------|

■ Stem-Mount 4" Travel Strut



Poly-Pad Mount

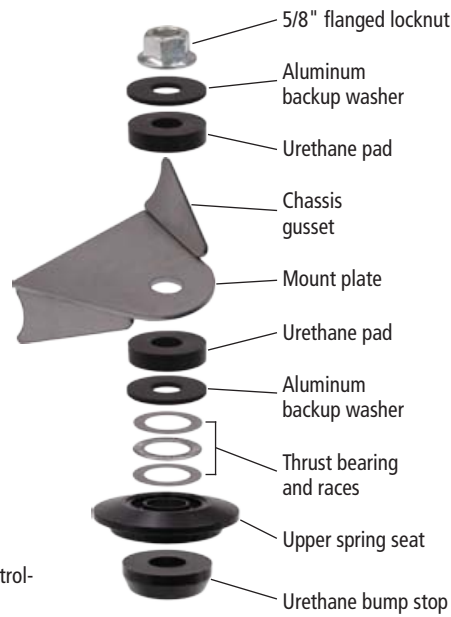

Spherical-Bearing Mount

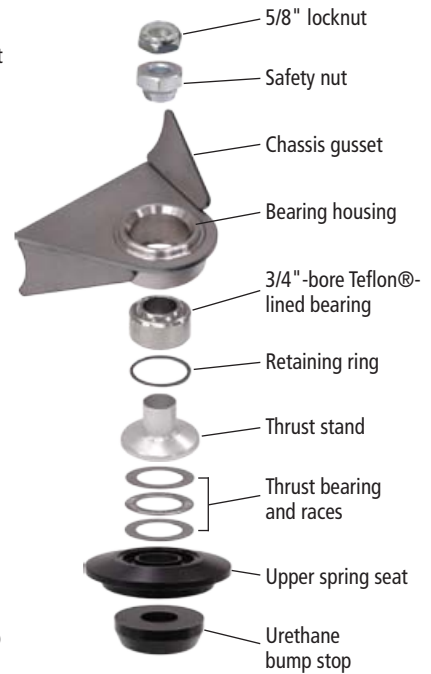

| | | |
|-------------|--|-----------|
| VAS 9012124 | STEM-MOUNT 4"-TRAVEL DRAG-RACE STRUT SYSTEM (PAIR) | \$2587.00 |
| VAS 505-100 | POLY-PAD, STRUT-TOP CHASSIS MOUNT | 39.00 |
| VAS 505-101 | SPHERICAL-BEARING CHASSIS MOUNT FOR STEM TOP | 159.00 |
| NOTE | MOUNTS ALSO FIT STRANGE STEM-MOUNT STRUTS | |

■ 6" Travel Stem-Mount Strut

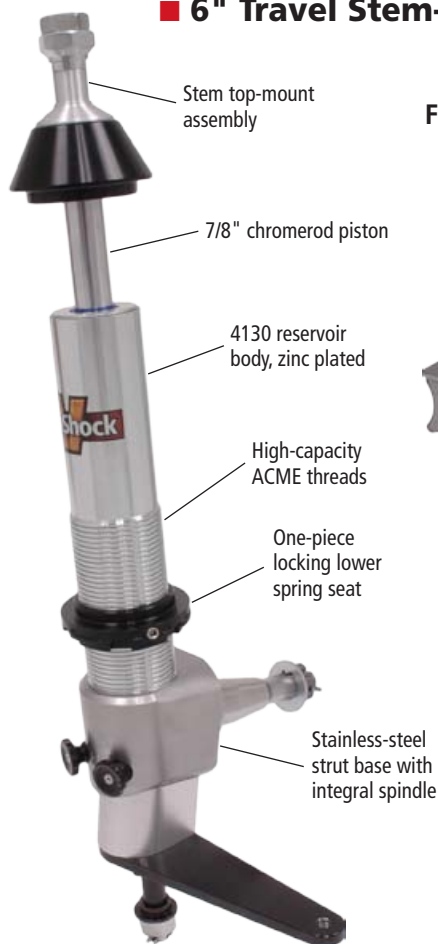

Fixed Mount

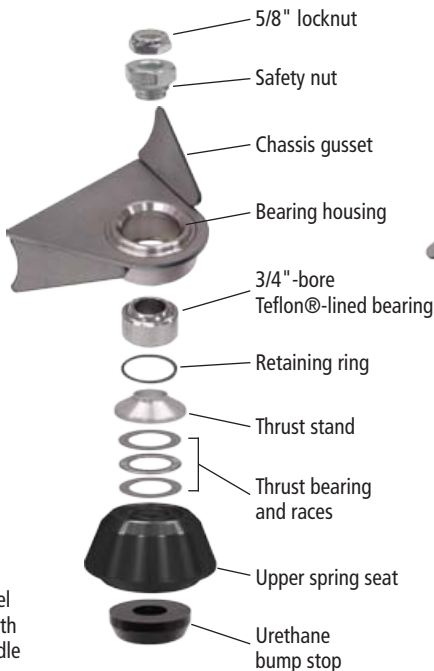

Adjustable Mount

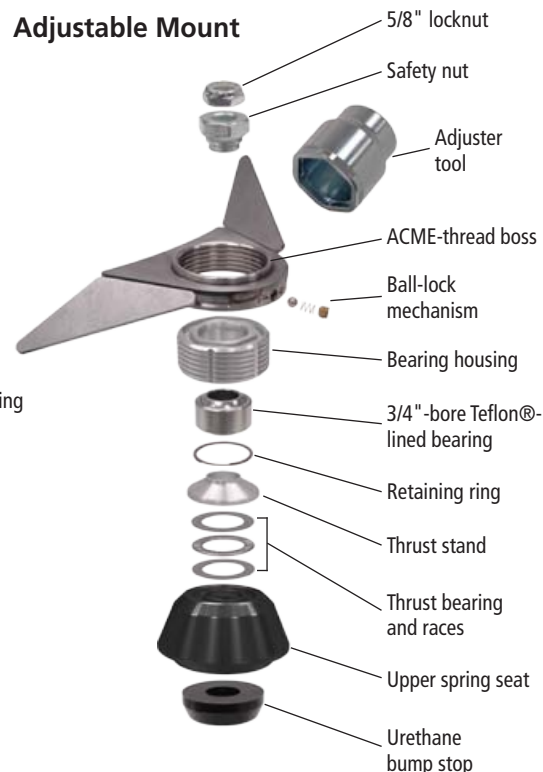

| | | |
|-------------|--|-----------|
| VAS 9012326 | STEM-MOUNT 6"-TRAVEL DRAG-RACE STRUT SYSTEM (PAIR) | \$2879.00 |
| VAS 505-102 | FIXED POSITION COM-12 CHASSIS MOUNT | 159.00 |
| VAS 505-103 | ADJUSTABLE HEIGHT COM-12 CHASSIS MOUNT | 259.00 |



■ Strut Tubular Tie-Rod Assemblies

Tie-rod tubes are designed to replace the stock-Pinto-rack tie rod with 5/8"-OD, 4130 tube. A 7/16" thread on the outboard end attaches a 3/8"-bore, high-misalignment, 4130-body, Teflon®-lined rod end to be used as a tie-rod end. The strut steering arm is attached to the rod end with the provided hardware and bump-steer shims.



| | | |
|------|--|----------|
| 6194 | TIE-ROD TUBES, 3/8 X 7/16", 4130 ROD ENDS (PAIR) | \$139.00 |
|------|--|----------|

VariStrut Integral Spindle

VariStrut Brake Options

Standard brake options include billet aluminum single-piston floating calipers with 10-1/4" rotors for spindle-mounted wheels or dual-piston fixed calipers with 10" rotors for hub-mounted wheels. A four-piston forged-aluminum caliper with 11-3/4" rotor option is also available for heavier vehicles. Optional slotted rotors can be selected to further reduce weight.



■ Spindle-Mount Brakes

- **Caliper:** Billet aluminum, single-piston, floating caliper (black anodized)
- **Rotor:** 10.25 x .25", slotted rotor
- **Hat:** Billet aluminum, silver-anodized finish
- **Fits:** Weld Racing Wheels - Alumastar 2.0 (788-15001) and Magnum Pro (786-15001 or 786P-15001) and American Racing Wheels - Torq Thrust® Pro (48553S) and TrakStar (48053SBC or 48053S)



| BRAKE OPTION | BRAKE SET FOR SPINDLE-MOUNT WHEELS (INCLUDED WITH STRUT) | INCLUDED |
|--------------|--|----------|
|--------------|--|----------|

■ Light-Duty Brakes

- **Caliper:** Billet aluminum, dual-piston, fixed caliper (black anodized)
- **Rotor:** 10.00 x .35", solid (optional slotted rotor shown)
- **Hub:** Billet aluminum, silver-anodized finish, 4-1/2" and 4-3/4" 5-lug patterns



| BRAKE OPTIONS | LIGHT-DUTY BRAKE SET, SOLID 10" ROTOR (INCLUDED WITH STRUT) | INCLUDED |
|---------------|---|-----------|
| | LIGHT-DUTY BRAKE SET, SLOTTED 10" ROTOR | ADD 20.00 |

■ Medium-Duty Brakes

- **Caliper:** Forged aluminum, four-piston, fixed caliper (black anodized or optional polished finish)
- **Rotor:** 11.75 x .35", solid (optional slotted rotor shown)
- **Hub:** Billet aluminum, silver-anodized finish, 4-1/2" and 4-3/4" 5-lug patterns



| BRAKE OPTIONS | MEDIUM-DUTY BRAKES, SOLID 11.75" ROTOR, BLACK CALIPERS | ADD 50.00 |
|---------------|---|------------|
| | MEDIUM-DUTY BRAKES, SLOTTED 11.75" ROTOR, BLACK CALIPERS | ADD 70.00 |
| | MEDIUM-DUTY BRAKES, SOLID 11.75" ROTOR, POLISHED CALIPERS | ADD 155.00 |
| | MEDIUM-DUTY BRAKES, SLOTTED 11.75" ROTOR, POLISHED CALIPERS | ADD 175.00 |

VariStrut Integral Spindle