

**Adjustable-Rate Rear Anti-Roll Bars for
 1964-72 GM A-Body Vehicles**

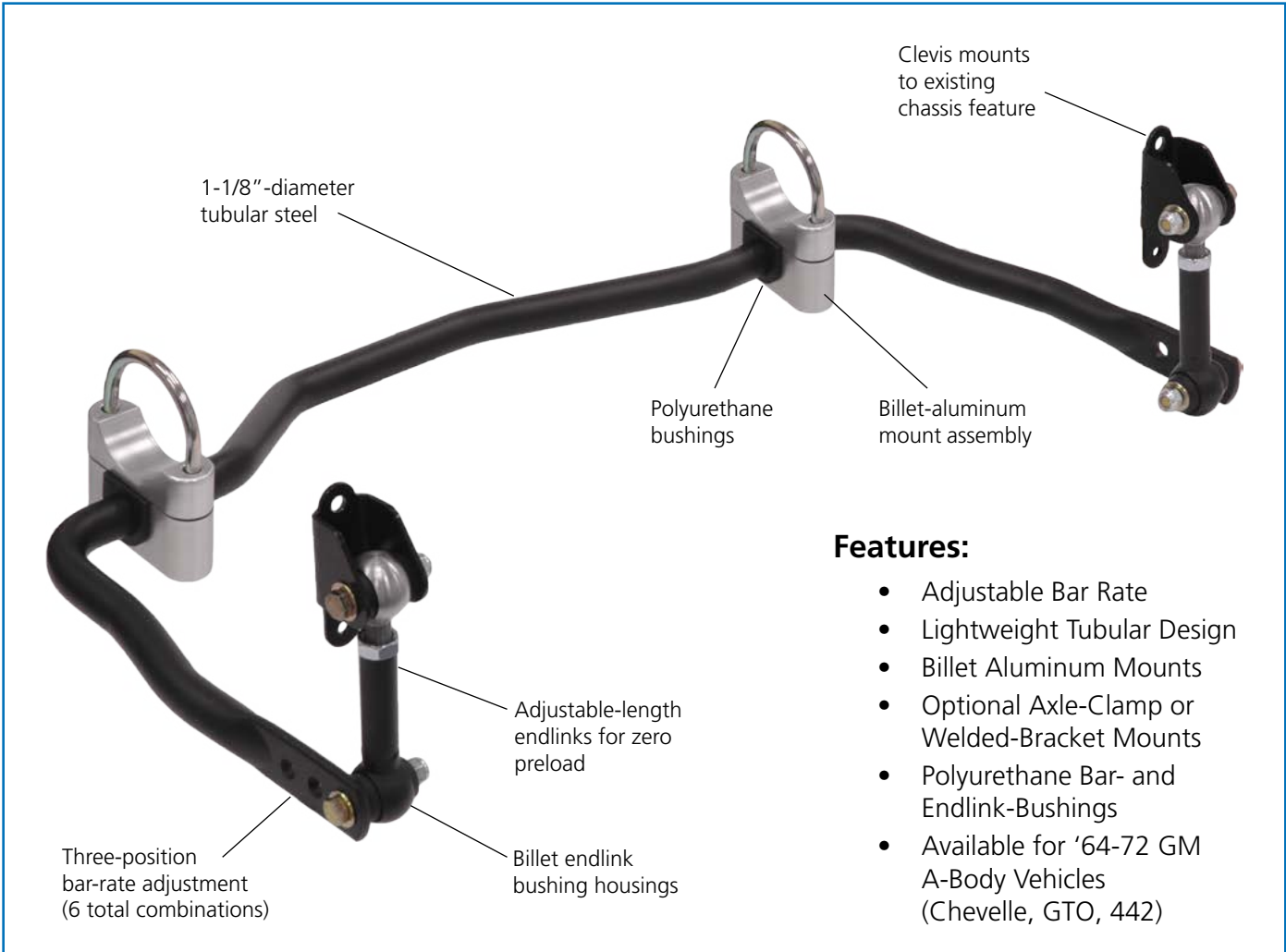

Features:

- Adjustable Bar Rate
- Lightweight Tubular Design
- Billet Aluminum Mounts
- Optional Axle-Clamp or Welded-Bracket Mounts
- Polyurethane Bar- and Endlink-Bushings
- Available for '64-72 GM A-Body Vehicles (Chevelle, GTO, 442)

A-Body Adjustable-Rate Rear Anti-Roll Bars

In addition to significantly reducing the rear suspension's unsprung weight, Chassisworks' tubular adjustable-rate rear anti-roll bars provide a quick and simple means for fine tuning the understeer/oversteer characteristics of your 1964-72 GM A-body vehicle. The tubular-steel endlinks can be mounted in three different positions along each bar end to change bar stiffness with a total of six different settings. Billet-steel urethane-bushing housings allow the anti-roll bar endlinks to be precisely set in a neutral, non-preloaded state. Existing factory crossmember holes are used to locate and mount the endlink clevises, however one additional hole must be drilled for each clevis.

The bar mounts to the OEM or FAB9 housings using one of two different style mounts. The first style, a billet aluminum axle-clamp mount, consists of a billet urethane-bushing housing and clamp seat, and 7/16" U-bolt for 3" axle tubes. Assembly hardware is hidden neatly inside the billet clamp with only the countersunk socket-head cap screws being visible from underneath. The second option uses a welded axle tube bracket with weld nuts, on which to mount the billet bushing housing. Brackets can be factory-welded when ordered with a Chassisworks FAB9 housing, or included separately for welding to your existing housing. Anti-roll bars ship with matte-black powder-coat finish and include endlinks, bushing mounts, urethane bushings, and required mounting hardware.



Endlink Adjustments



Position Adjustment

The three endlink mounting positions affect the overall stiffness of the bar. The outmost position (used above) softens the bar's spring rate, provides more cornering grip at the rear wheels, and adjusts more toward vehicle understeer. This is the recommended starting position. Mounting at the two inner holes shortens the arm and stiffens the bar, resulting in less rearend cornering grip and adjusts more toward an oversteering condition. Additional variables such as suspension geometry and tire size also greatly affect handling. The position adjustment is merely an easily tunable variable in the overall suspension system.

Length Adjustment

The length of the each endlink is adjusted to remove any preload from the bar when the vehicle is at rest. Severely preloaded anti-roll bars will have different cornering characteristics from one direction to the other. Removing preload balances the anti-roll bar's affect on vehicle dynamics in either direction.

Bolt-On Axle Clamp Mount

The billet axle-clamp assembly allows easy installation with OEM 10-bolt and 12-bolt rearends, and Chassisworks FAB9 housings with 3" diameter axle tubes. By far, the cleanest U-bolt-style anti-roll bar mount available.



Weld-On Mount

Weld-on mounts are available on factory-welded FAB9™ housings or packaged for weld-on installation with your existing rearend housing. Weld-nuts in the axle bracket eliminate the unsightly U-bolt and are the perfect solution for extremely clean installations.

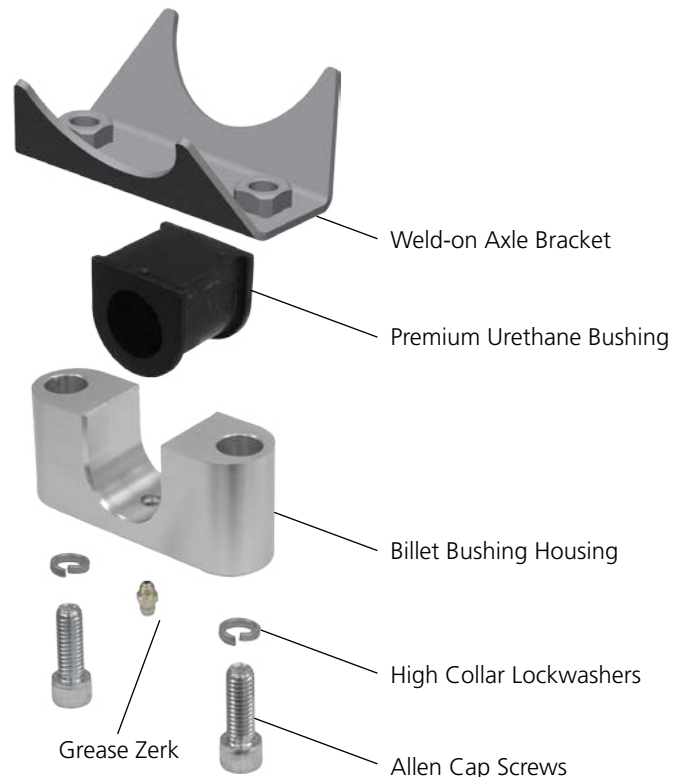

Applications

Part Number	Year	Make/Model	Make & Model
5825-A10-18-AF	1964-1967	GM A-Body	FAB9™ Mount, 1-1/8"-diameter adjustable rear anti-roll bar
5825-A10-18-AU	1964-1967	GM A-Body	U-Bolt Mount, 1-1/8"-diameter adjustable rear anti-roll bar
5825-A10-18-AW	1964-1967	GM A-Body	Weld-On Mount, 1-1/8"-diameter adjustable rear anti-roll bar
5825-A20-18-AF	1968-1972	GM A-Body	FAB9™ Mount, 1-1/8"-diameter adjustable rear anti-roll bar
5825-A20-18-AU	1968-1972	GM A-Body	U-Bolt Mount, 1-1/8"-diameter adjustable rear anti-roll bar
5825-A20-18-AW	1968-1972	GM A-Body	Weld-On Mount, 1-1/8"-diameter adjustable rear anti-roll bar

Related Products

Chassisworks manufactures a broad range of suspensions components for '64-72 A-body vehicles, ranging from control arm support braces to complete pro-touring and drag-race suspension systems. Visit the Chassisworks E-Store for additional information.

[CLICK for More Info Online](#)



All prices subject to change. Current pricing available at www.cachassisworks.com.



Chris Alston's Chassisworks, Inc.
8661 Younger Creek Drive
Sacramento, CA 95828

Order: 800-722-2269
Tech: 916-388-0288
Fax: 916-388-0295

sales@cachassisworks.com
www.cachassisworks.com