

READ ALL INSTRUCTIONS COMPLETELY AND THOROUGHLY UNDERSTAND THEM BEFORE DOING ANYTHING.
CALL CHASSISWORKS TECH SUPPORT (916) 388-0288 IF YOU NEED ASSISTANCE.

INSTALLATION GUIDE



300-0164

g-Bar/g-Link Multi-Leaf-Spring-Mount Lowering Blocks



Description:

Lowering block set moves g-Bar axle bracket 1-1/4" down, lowering the vehicles ride height.

Applications: Chassisworks g-Bar and g-Link suspensions with billet-aluminum shock mount.

Note: This lowering kit alters the rear ride height below the operating range that was originally intended for the g-Bar and g-Link suspension systems. Installation requires that vehicle clearance and suspension misalignment be verified to ensure there is no binding or contact with the chassis. Suspension travel must be limited using chassis bump stops to prevent bottoming out and damaging the shocks. Cutting the underbody may also be required for drivetrain clearance.

ITEM	QTY	PART NO.	DESCRIPTION
1	4	7959-0110	LOWERING BLOCK, 1 1/4, G-BAR
2	4	3147-300.50-775	U-BOLT, AXLE TUBE, 1/2-20 x 3.00 x 7.75
3	8	3120-050S-Y	FLAT WASHER, 1/2 SAE, HARDENED, YELLOW ZINC
4	8	3131-050-20Y	LOCKNUT 1/2-20, GRADE 8, NYLON INSERT, YELLOW ZINC

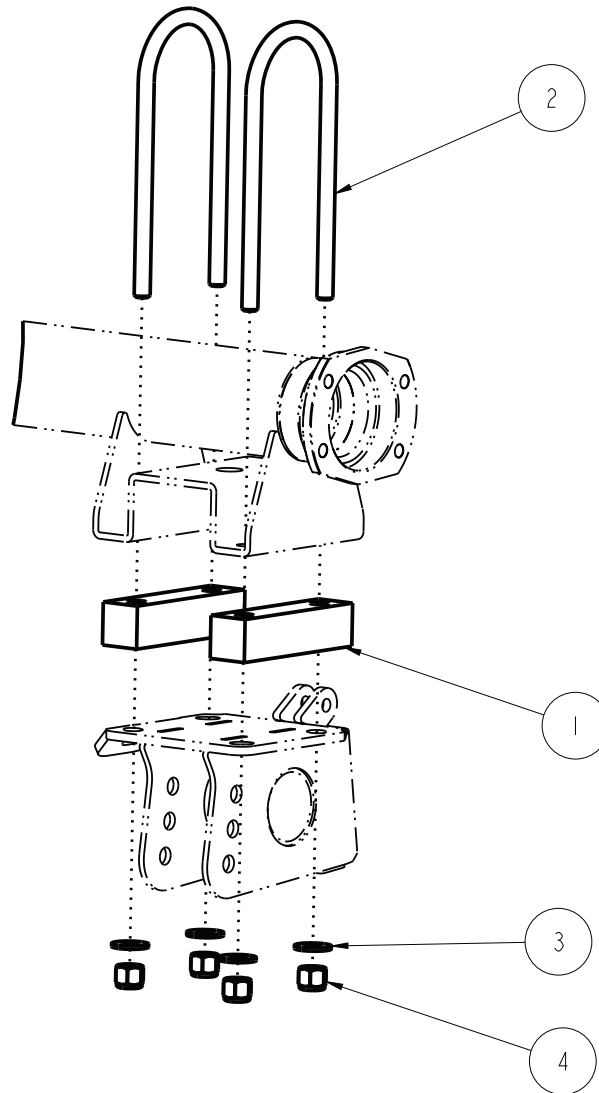

DESCRIPTION		LOWERING BLOCKS, G-BAR MULTI-LEAF	
<i>Chris Alston's</i> CHASSISWORKS INC. 8661 YOUNGER CREEK DRIVE SACRAMENTO, CA 95828 (916) 388-0288 FAX 388-0295		PART NO.	300-0164
		4/24/12	DWG: 91300-0164

PARTS LIST

300-0163 - g-Bar Lowering Block Set

Qty	Part Number	Description
8	3120-050S-Y	Flat washer 1/2" hardened
8	3131-050-20Y	Locknut 1/2-20 grade 8 hardened
4	3147-300.50-775	U-bolt axle tube 1/2-20 x 3.00" x 7.75"
2	7959-0110	Lowering block 1-1/4" g-Bar/g-Link

INSTRUCTIONS

If you are installing the g-Bar/g-Link for the first time, start at step 4.

1. If you already have the g-Bar/g-Link installed raise the car off the ground and put jack stands under the rocker panels.
2. Support the driver side of the rear end housing on the axle tube, so the lower link bar axle mount can be removed.
3. Unbolt the coil-over shock from the billet mount. Remove the U-bolts.
4. Place the block between the leaf spring mount on the housing and the axle bracket. Install the flat washers and locknuts. Tighten evenly to 60 lb-ft.



WARRANTY NOTICE:

There are NO WARRANTIES, either expressed or implied. Neither the seller nor manufacturer will be liable for any loss, damage or injury, direct or indirect, arising from the use or inability to determine the appropriate use of any products. Before any attempt at installation, all drawings and/or instruction sheets should be completely reviewed to determine the suitability of the product for its intended use. In this connection, the user assumes all responsibility and risk. We reserve the right to change specification without notice. Further, Chris Alston's Chassisworks, Inc., makes **NO GUARANTEE** in reference to any specific class legality of any component. **ALL PRODUCTS ARE INTENDED FOR RACING AND OFF-ROAD USE AND MAY NOT BE LEGALLY USED ON THE HIGHWAY.** The products offered for sale are true race-car components and, in all cases, require some fabrication skill. **NO PRODUCT OR SERVICE IS DESIGNED OR INTENDED TO PREVENT INJURY OR DEATH.**

Chris Alston's Chassisworks
8661 Younger Creek Drive
Sacramento, CA 95828
Phone: 916-388-0288
Technical Support: sales@cachassisworks.com

