

# INSTALLATION GUIDE



## KPC 4LTW-U01

### Universal Fit Weld-In Triangulated 4-Link Kit



**Description:** Weld-in, urethane-bushed 4-link rear suspension for universal vehicle use. Includes brackets for fabricated suspension crossmember and axle housing, adjustable-length suspension links, urethane end bushings, and mounting hardware.

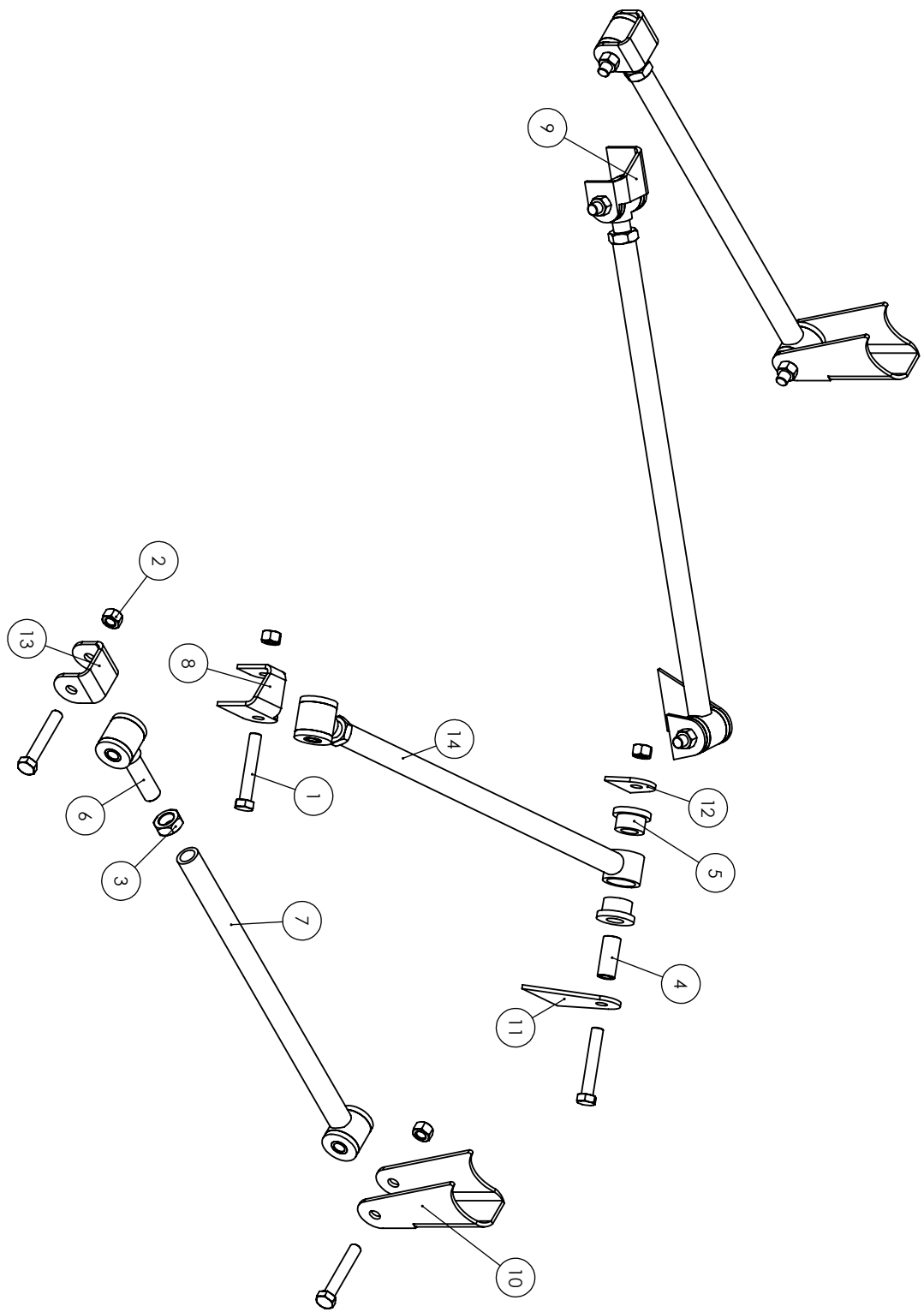

DESCRIPTION

4-LINK TRIANGULATED BARS UNIVERSAL WELD IN

<b>KP Components</b> 8661 Younger Creek Dr Sacramento, CA 95828 KPrech@cachassisworks.com	PART NO <b>KPC 4LTW-U01</b>
--	--------------------------------

ITEM NO.	PART NUMBER	DESCRIPTION	QTY.
1	3100-050F3.00Y	BOLT 1/2-20 x 3" HEX CAP SCREW GRADE 8	8
2	3101-050-20C	LOCKNUT 1/2-20 NYLON INSERT PLATED	8
3	3102-075-16RC	JAM NUT 3/4-16 RH GRADE 5	4
4	3140-1624-56	SLEEVE 1/2 X 3/4 X 1 3/4 LONG FOR POLY BUSHING	8
5	3141-2440-0.88	POLY BUSHING .75 BORE X .875 OAL X 1.25 BARREL OD X .625 BARREL LENGTH X 1.625 FLANGE OD X .25 FLANGE WIDTH	16
6	7930-003	POLY EYE KP WELDMENT 3/4-16 x 1-1/4 BORE RIGHT HAND	4
7	7930-11-17.70	LINK BAR WELDMENT 17.70 OAL X 3/4-16 RIGHT X 90° - 1.25 BORE POLY HOUSING	2
8	7930-117	4LINK FRONT DR CHASSIS MOUNT #117	1
9	7930-118	4LINK FRONT PS CHASSIS MOUNT #118	1
10	7930-119	4LINK DR/PS AXLE MOUNT #119	2
11	7930-120	4LINK LONG UPPER OUTER AXLE MOUNT #120	2
12	7930-121	4LINK SHORT UPPER INNER AXLE MOUNT #121	2
13	7935-016	PANHARD FRAME BRACKET 016,	2
14	7930-11-22.70	LINK BAR WELDMENT 22.70 OAL X 3/4-16 RIGHT X 90° - 1.25 BORE POLY BUSHING	2
15	3151-1/2OZ	POLY LUBE 1/2 oz. CUP	

WAS - WO4L-01

DESCRIPTION

**4-LINK TRIANGULATED BARS UNIVERSAL WELD IN**

**KP Components**  
8661 Younger Creek Dr  
Sacramento, CA 95828  
KPrech@cachassisworks.com

PART NO

**KPC 4LTW-U01**

SHEET 2 OF 2

**WARRANTY NOTICE:**

There are NO WARRANTIES, either expressed or implied. Neither the seller nor manufacturer will be liable for any loss, damage or injury, direct or indirect, arising from the use or inability to determine the appropriate use of any products. Before any attempt at installation, all drawings and/or instruction sheets should be completely reviewed to determine the suitability of the product for its intended use. In this connection, the user assumes all responsibility and risk. We reserve the right to change specification without notice. Further, Chris Alston's Chassisworks, Inc., makes **NO GUARANTEE** in reference to any specific class legality of any component. **ALL PRODUCTS ARE INTENDED FOR RACING AND OFF-ROAD USE AND MAY NOT BE LEGALLY USED ON THE HIGHWAY.** The products offered for sale are true race-car components and, in all cases, require some fabrication skill. **NO PRODUCT OR SERVICE IS DESIGNED OR INTENDED TO PREVENT INJURY OR DEATH.**

KP Components  
A Chris Alston's Chassisworks Inc., Brand  
8661 Younger Creek Drive  
Sacramento, CA 95828  
Technical Support: [KPtech@cachassisworks.com](mailto:KPtech@cachassisworks.com)

