

INSTALLATION GUIDE



6725

**g-Bar Upper Axle Bracket Weld Fixture
for '70-81 Camaro/Firebird with Ford 9" Housing**



Description: Bolt-on fixture for welding g-Bar upper axle brackets onto Ford 9" rearend housings. For use with all 1970-81 Camaro and Firebird, g-Bar and g-Link rear suspension systems.

Note: Fixture can be configured for welding with the stock-housing cover plate installed or removed.

PART NO.

6725

SHEET

REV.

1

0

THIS DRAWING CONTAINS PROPRIETARY INFORMATION OF CHRIS ALSTON'S CHASSISWORKS, INC. AND SHALL NOT BE REPRODUCED, TRANSFERRED TO OTHER DOCUMENTS, DISCLOSED TO OTHERS, USED FOR MANUFACTURING, OR FOR ANY OTHER PURPOSE, IN WHOLE OR IN PART WITHOUT PRIOR WRITTEN PERMISSION OF CHRIS ALSTON'S CHASSISWORKS, INC.

REVISIONS

ZONE	REV	DESCRIPTION	DATE	APPROVED
------	-----	-------------	------	----------

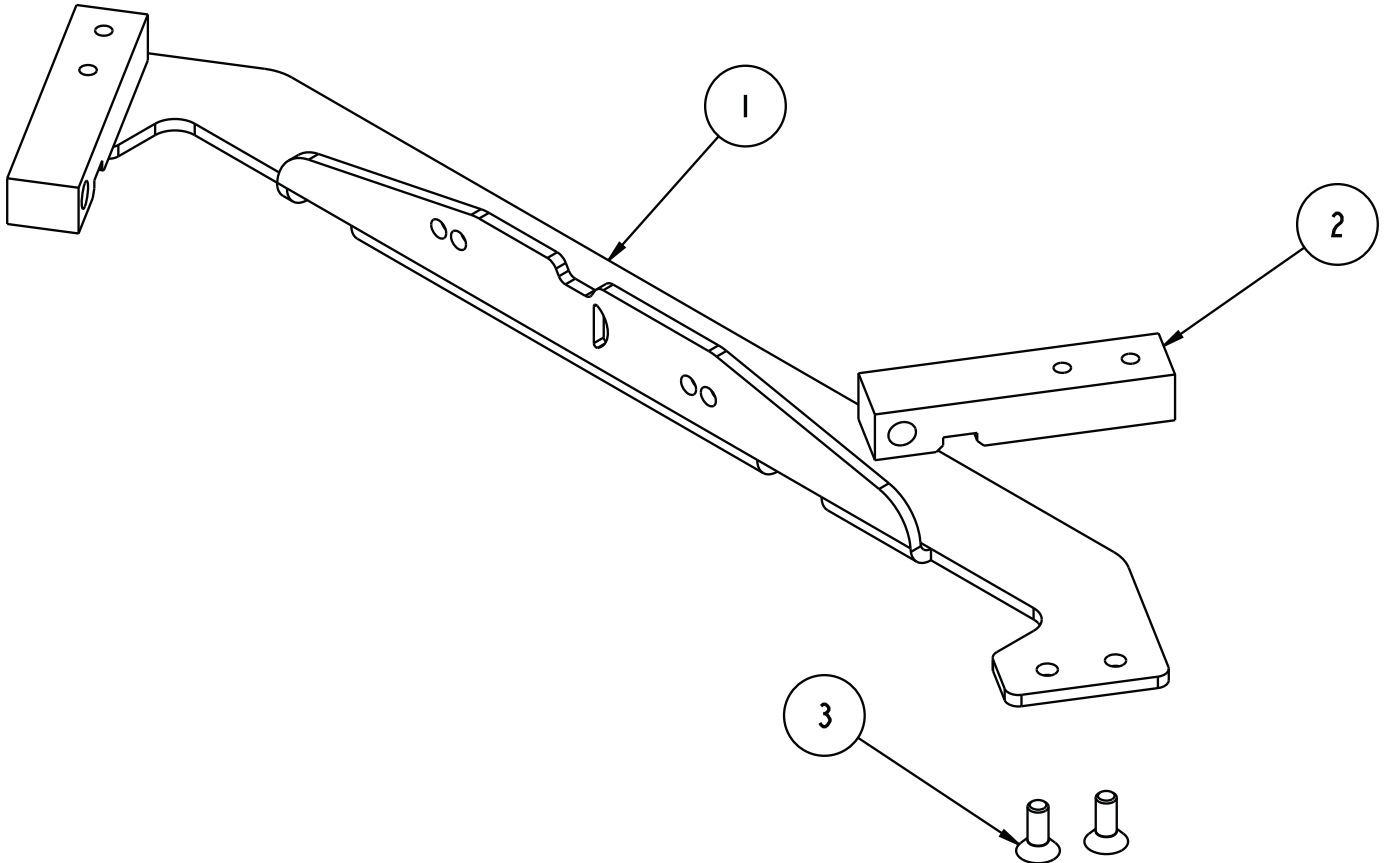

ITEM	QTY	PART NO.	DESCRIPTION
1	1	7959-0052	WELD FIXTURE BRACKET, UCA AXLE BRKT, G-BAR, FORD 9", 70-81 CAMARO
2	2	1480	BRACKET LOCATOR, UCA WELD FIXTURE, G-BAR HOUSING
3	4	3105-038C1.00B	FLAT HEAD SOCKET CAP SCREW, 3/8-16 x 1, BLACK OXIDE
UNLESS OTHERWISE SPECIFIED		APPROVALS	DATE
DIMENSIONS ARE IN INCHES		DRAWN BY:	1/10/11
TOLERANCES		D. HOESCHEN	
FRACTIONS	ANGLES	DECIMAL	
±1/16	±.5	±.1	
	±.05	±.01	
	±.005	±.005	
		±.0010	
		CHECKED BY:	1/10/11
		S. RIEGER	
		DWG RELEASE LEVEL: In Work	
DESCRIPTION			
BRACKET FIXTURE, FORD 9", G-BAR UCA BRACKET, 70-81 CAMARO			
Chris Alston's CHASSISWORKS INC. 8661 YOUNGER CREEK DRIVE SACRAMENTO, CA 95828 (916) 388-0288 FAX 388-0295			
FINISH		SIZE	PART NO.
NONE		A	6725
MATERIAL		PART REV.	
ASSEMBLY		0	
SCALE: 1:4		DWG: 6725 REV: 0.1	
		SHEET 1 OF 1	

PARTS LIST

6725 - g-Bar Weld Fixture, Ford 9", '70-81 Camaro/Firebird

Qty	Part Number	Description
2	1480	Bracket locator block for g-Bar upper link
4	3105-038C1.00B	Flat head 3/8-16 x 1" flat head cap screw, black oxide
1	7959-0052	Arm mount fixture plate for Ford 9", '70-81 Camaro/Firebird

This fixture correctly locates the g-Bar upper axle brackets for welding to the rearend housing. It has been designed for bolt-on use with a standard Ford 9" bolt pattern, but can also be used on 8" Ford housings by measuring from each housing end to the closest bracket to ensure the brackets are centered, and then clamping it to the housing face.

INSTRUCTIONS

1. Remove axles from the rearend housing. Leave third-member installed for next step.
2. You must determine pinion location in relation to the axle housing ends.
3. Place a carpenter's square or straight edge against the driver-side housing end so it extends forward for easier measurement.
4. Measure from the driver-side housing end (carpenter's square) to the pinion centerline and record this dimension.
5. Repeat measurement steps for the passenger side. If both measurements are equal, the pinion has zero offset. If there is a one-inch difference in measurement, the pinion has a 1/2" offset to the passenger side.
6. Make note of the pinion offset, and then remove the third member from the rearend housing.
7. Slide the mounting plate over the two upper studs using the correct set of holes based on the pinion offset calculated in the proceeding steps; zero or 1/2". (Figure 2-1 shows assembly using centered pinion position.) With the mounting plate in the correct location, the outside end of the plate will be an equal distance from each rear housing end.
8. Secure the bracket locating blocks to the mount plate using 3/8" flat head cap screws.
Note: The tapered body of the flat head cap screw aligns the block as each screw is tightened.
9. Slide g-bar UCA axle bracket over the driver-side block and seat against the axle tube. The bracket's edge should fit tightly along the axle tube, with the bend corners extending vertically.
10. Use one mounting bolt and locknut to secure the bracket's orientation with the hardware supplied in the g-Bar kit. If the bracket and locating block do not align correctly, you may need to grind the bracket to better fit the axle tube.
11. Repeat steps for passenger side using axle mount.

12. Measure from the housing end to the UCA axle bracket on both sides. They must be the same distance from each housing end.
13. The brackets can now be tack-welded then measured again to verify correct positioning.
14. Weld completely around each bracket where it meets the axle tube. Leave the fixture in place until the housing is completely cooled to minimize axle tube warping from welding.
15. You can now reinstall the third-member, axles, and brakes on the rear end housing, and continue with installation of the g-Bar rear suspension system.

WARRANTY NOTICE:

There are **NO WARRANTIES**, either expressed or implied. Neither the seller nor manufacturer will be liable for any loss, damage or injury, direct or indirect, arising from the use or inability to determine the appropriate use of any products. Before any attempt at installation, all drawings and/or instruction sheets should be completely reviewed to determine the suitability of the product for its intended use. In this connection, the user assumes all responsibility and risk. We reserve the right to change specification without notice. Further, Chris Alston's Chassisworks, Inc., makes **NO GUARANTEE** in reference to any specific class legality of any component. **ALL PRODUCTS ARE INTENDED FOR RACING AND OFF-ROAD USE AND MAY NOT BE LEGALLY USED ON THE HIGHWAY.** The products offered for sale are true race-car components and, in all cases, require some fabrication skill. **NO PRODUCT OR SERVICE IS DESIGNED OR INTENDED TO PREVENT INJURY OR DEATH.**

Chris Alston's Chassisworks
8661 Younger Creek Drive
Sacramento, CA 95828
Phone: 916-388-0288
Technical Support: tech@cachassisworks.com

