

READ ALL INSTRUCTIONS COMPLETELY AND THOROUGHLY UNDERSTAND THEM BEFORE DOING ANYTHING.
CALL CHASSISWORKS TECH SUPPORT (916) 388-0288 IF YOU NEED ASSISTANCE.

INSTALLATION GUIDE



6731

**g-Street Torque Arm Bracket Weld Fixture
for Lower Axle-Housing Brackets on Ford 9"**



Description: Bolt-on fixture for welding g-Street lower torque-arm axle brackets onto Ford 9" rearend housings. For use with all Chassisworks g-Street torque-arm suspension systems.

Return Note: Can be returned for partial refund if within 60 days of invoice and all parts are in good condition. Cannot be returned if any part is missing. An RA number is required

PART NO.

6731

SHEET

1

REV.

0

THIS DRAWING CONTAINS PROPRIETARY INFORMATION OF CHRIS ALSTON'S CHASSISWORKS, INC. AND SHALL NOT BE REPRODUCED, TRANSFERRED TO OTHER DOCUMENTS, DISCLOSED TO OTHERS, USED FOR MANUFACTURING, OR FOR ANY OTHER PURPOSE, IN WHOLE OR IN PART WITHOUT PRIOR WRITTEN PERMISSION OF CHRIS ALSTON'S CHASSISWORKS, INC.

REVISIONS

ZONE	REV	DESCRIPTION	DATE	APPROVED
------	-----	-------------	------	----------

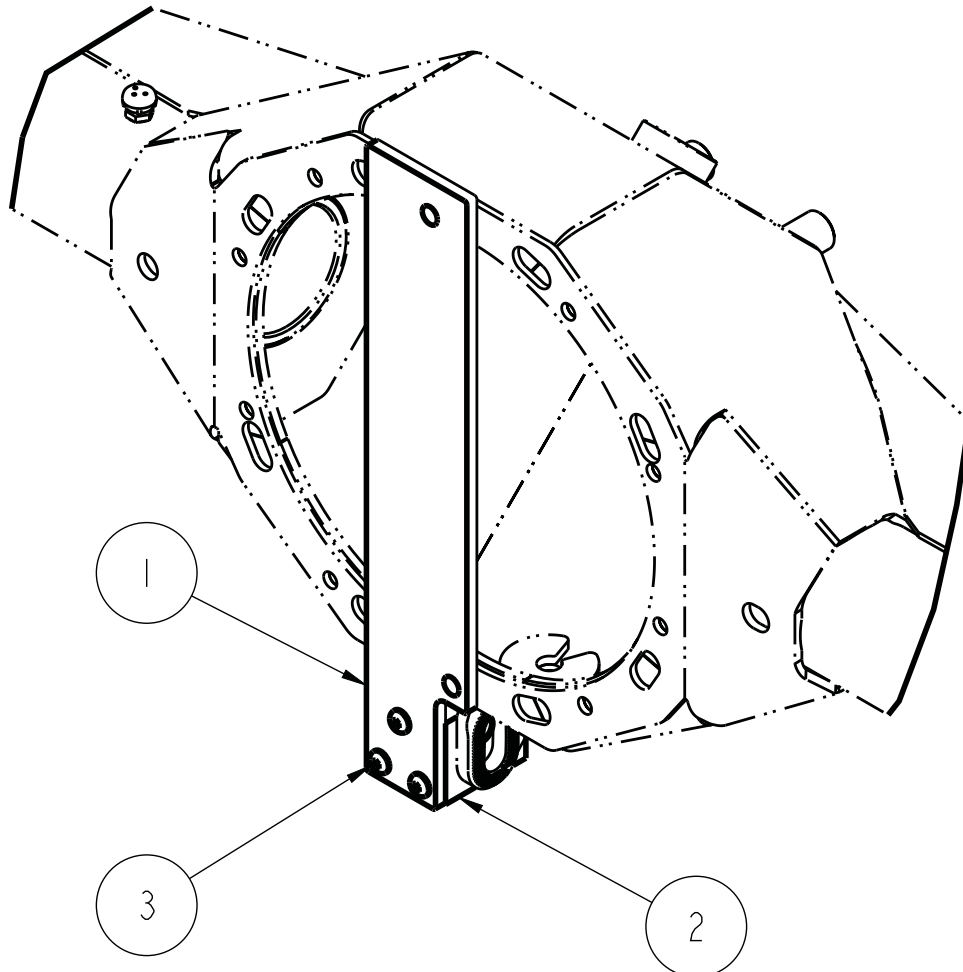

ITEM	QTY	PART NO.	DESCRIPTION
1	1	7959-0311	SUPPORT, LOCATOR BLOCK, TQ-ARM TABS, G-LINK, G-STREET, FAB9, FORD 9
2	1	7959-0310	LOCATOR BLOCK, TQ-ARM TABS, G-LINK, G-STREET, FAB9, FORD 9
3	3	3104-025C0.63C	BUTTON HEAD SOCKET CAP SCREW, 1/4-20 x 5/8, CLEAR ZINC
UNLESS OTHERWISE SPECIFIED		APPROVALS	DATE
DIMENSIONS ARE IN INCHES TOLERANCES FRACTIONS ANGLES DECIMAL $\pm 1/16$ $\pm .5$ $\pm .1$ $\pm .05$ $\pm .01$ $\pm .005$ $\pm .005$ $\pm .0010$		DRAWN BY: D. HOESCHEN	1/27/15
		CHECKED BY: S. RIEGER	2/3/15
		DWG RELEASE LEVEL: In Work	
FINISH NONE		DESCRIPTION BRACKET FIXTURE, TQ-ARM TABS, G-LINK, G-STREET, FAB9, FORD 9	
MATERIAL ASSEMBLY		Chris Alston's CHASSISWORKS INC. 8661 YOUNGER CREEK DRIVE SACRAMENTO, CA 95828 (916) 388-0288 FAX 388-0295	
		SIZE A	PART NO. 6731
		PART REV. 0	
		SCALE: 13:64	DWG: 6731 REV: 0.1
		SHEET 1 OF 1	

PARTS LIST

6731 - g-Street Torque Arm Weld Fixture, Ford 9"

Qty	Part Number	Description
1	7959-0310	Bracket locator block for g-Street torque arm
1	7959-0311	Fixture plate for Ford 9"
3	3104-025C0.63C	Cap screws 1/4-20 x 5/8", button head

INSTRUCTIONS

This fixture correctly locates the lower housing brackets for welding to a Ford 9" rearend housing. It has been designed for bolt-on use. Third-member must be removed.

1. Use your existing third-member hardware to mount the fixture plate onto the bare housing face. The plate located on the center holes at the top and bottom of the bolt pattern. The plate must seat directly against the housing.
2. Mount the locator block to the fixture plate using the three button-head cap screws supplied.
3. The torque arm tabs and serated washers are then mounted to the locator block.
4. Loosely assemble the washers and tabs onto the locator block using the 1/2" bolt from the torque arm hardware. The flat surface of each tab must be against the locator block with the serated surfaces of the tabs and washers facing toward each other.
5. Push the tabs against the housing before interlocking the serations and tightening the hardware.

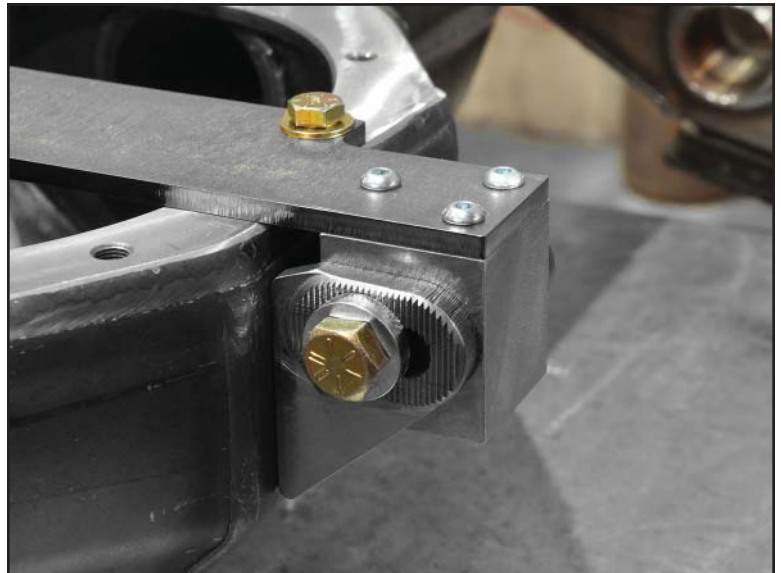

Chassisworks FAB9 - Verify the tabs are seated flat against the housing with no significant gaps.

Other Housings - It is extremely important that the tabs are placed at equal height to one another for the serations adjustment to work properly. Tightening the hardware aligns the serations, however each tab may need to be ground to ensure a good fit without significant gaps.

6. Once correctly fit, the tabs can be welded to the housing.
7. Let the welds completely cool before removing the fixture.

WARRANTY NOTICE:

There are **NO WARRANTIES**, either expressed or implied. Neither the seller nor manufacturer will be liable for any loss, damage or injury, direct or indirect, arising from the use or inability to determine the appropriate use of any products. Before any attempt at installation, all drawings and/or instruction sheets should be completely reviewed to determine the suitability of the product for its intended use. In this connection, the user assumes all responsibility and risk. We reserve the right to change specification without notice. Further, Chris Alston's Chassisworks, Inc., makes **NO GUARANTEE** in reference to any specific class legality of any component. **ALL PRODUCTS ARE INTENDED FOR RACING AND OFF-ROAD USE AND MAY NOT BE LEGALLY USED ON THE HIGHWAY.** The products offered for sale are true race-car components and, in all cases, require some fabrication skill. **NO PRODUCT OR SERVICE IS DESIGNED OR INTENDED TO PREVENT INJURY OR DEATH.**

Chris Alston's Chassisworks
8661 Younger Creek Drive
Sacramento, CA 95828
Phone: 916-388-0288
Technical Support: tech@cachassisworks.com

