

READ ALL INSTRUCTIONS COMPLETELY AND THOROUGHLY UNDERSTAND THEM BEFORE DOING ANYTHING.
CALL CHASSISWORKS TECH SUPPORT (916) 388-0288 IF YOU NEED ASSISTANCE.

INSTALLATION GUIDE



5857-U04 Custom-Fit Torque Arm g-Link Suspension for Customer Frame



Description: Torque arm g-Link suspension for custom installation. Available with various torque arm and control arm lengths to accommodate a broad range of wheelbase and geometry requirements.

Includes: Torque arm, lower control arms, shocks, and axle housing brackets.

Options: Torque arm length, front pivot style, front crossmember, pinion mount, lower control arm length and style, coil-over or air-spring shocks, shock valving, splined anti-roll bar

Notes: Product must be custom-fit to vehicle. Trimming and welding required for installation. Not for use with 10- or 12-bolt Chevy housings. Requires Watts link (5855-U01) or panhard bar (5856-U01) for operation; sold separately.

- SPECIAL ORDER PART NOT RETURNABLE FOR ANY REASON -

DESCRIPTION

TORQUE ARM, G-LINK, UNIVERSAL

Chris Alexon's CHASSISWORKS INC.
8661 YOUNGER CREEK DRIVE
SACRAMENTO, CA 95828
(916) 388-0288 FAX 388-0295

PART NO. **5857-U04**

3/10/17 DWG: 7951-5857U0204

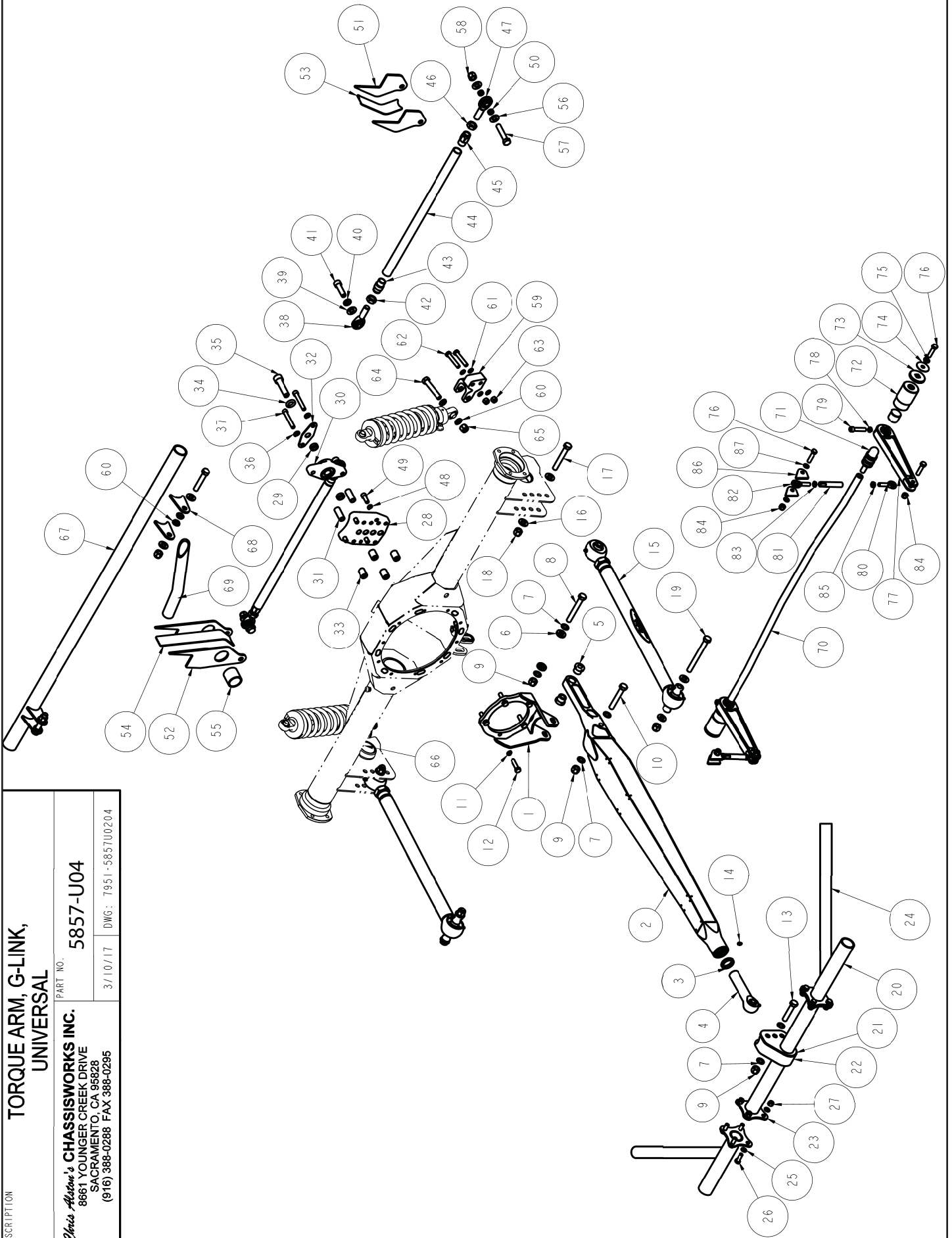

ITEM QTY	PART NO.	DESCRIPTION
1	7959-2002	TORQUE ARM MOUNT, G-STREET PINION SUPPORT, STRANGE ST IRON
2	7959-0280	TORQUE ARM WELDMENT, 70-73 CAMARO
3	899-016-1.125-W	WIPEr, 1 1/8 PISTON ROD, HALLITE 8880710
4	7959-0175	SLIDING LINK ASSY, TORQUE ARM, 1.10 BALL PIVOT
5	7959-0287	ADJUSTER, TORQUE ARM, 7/8-14 THREAD
6	7959-0288	WASHER, SERRATED, <input type="checkbox"/> 1/2
7	3109-050-S-2-Y	AIRCRAFT WASHER 1/2 x .062 THICK
8	3100-050F3.75Y	HEX BOLT, 1/2-20 x 3 3/4, GRADE 8, YELLOW ZINC
9	3101-050-20C	LOCKNUT, 1/2-20, GRADE 5, NYLON INSERT, CLEAR ZINC
10	3100-050F3.25Y	HEX BOLT, 1/2-20 x 3 1/4, GRADE 8, YELLOW ZINC
11	3109-038-S-2-Y	AIRCRAFT WASHER 3/8 x .062 THICK
12	3100-038C1.50Y	HEX BOLT, 3/8-16 x 1 1/2, GRADE 8, YELLOW ZINC
13	3100-050F2.50Y	HEX BOLT, 1/2-20 x 2 1/2, GRADE 8, YELLOW ZINC
14	3144-25-28-0	GREASE ZERK 1/4-28 STRAIGHT
15	3813-24.00-AE	LOWER LINK ASSEMBLY, G-LINK, 3.710 PIVOT BALL, 24 CENTER
16	3120-050S-Y	FLAT WASHER, 1/2 SAE, HARDENED, YELLOW ZINC
17	3100-050C3.50Y	HEX BOLT, 1/2-13 x 3 1/2, GRADE 8, YELLOW ZINC
18	3101-050-13C	LOCKNUT 1/2-13, GRADE 5, NYLON INSERT, CLEAR ZINC
19	3100-050C5.00Y	HEX BOLT, 1/2-13 x 5, GRADE 8, YELLOW ZINC
20	E26.134-036.000	STEEL TUBE <input type="checkbox"/> 1/4 x 36
21	7959-0328	PIVOT BRACKET, TORQUE ARM, 3 HOLE
22	7959-0329	GUSSET, PIVOT BRACKET, TORQUE ARM, 3 HOLE
23	7959-0184	TUBE CONNECTOR FLANGE, 1 5/8 MILD STEEL
24	E20.120-036.000	STEEL TUBE, <input type="checkbox"/> 1/4 x .120 ERW x 36.000 LONG
25	3109-038-S-2-Y	AIRCRAFT WASHER 3/8 x .062 THICK
26	3100-038C1.00Y	HEX BOLT, 3/8-16 x 1, GRADE 8, YELLOW ZINC
27	3101-038-16C	LOCKNUT 3/8-16, GRADE 5, NYLON INSERT, CLEAR ZINC
28	7959-2012	MOUNTING PLATE, WATTS LINK, 4 POSITION ADJUSTABLE, FAB-9
29	7959-2014	SPACER, <input type="checkbox"/> 7/8 OD x .120 WALL x .313 LONG
30	7959-2026	BEL- CRANK ASSEMBLY, WATTS LINK, G-STREET
31	7959-2015	SPACER, <input type="checkbox"/> 5/8 OD x .120 WALL x 1.625 LONG
32	7959-2016	TOP PLATE, G-STREET WATTS LINK
33	7959-2017	STANDOFF, G-STREET WATTS LINK
34	3108-063L-C	LOCK WASHER <input type="checkbox"/> 5/8, SPRING
35	3103-063C2.50B	SOCKET HEAD CAP SCREW, 5/8-11 x 2 1/2, BLACK OXIDE
36	3108-038L-C	LOCK WASHER, HELICAL SPRING <input type="checkbox"/> 3/8, STEEL, ZINC
37	3103-038C2.50C	SOCKET HEAD CAP SCREW, GRADE 8, 3/8-16 x 2 1/2, CLEAR ZINC
38	3136-063X050-RT	ROD END, 5/8- 8 RIGHT x 1/2 BORE CMX10-8T-FI
39	3151-050S-C	WASHER, 1/2 SAE, ZINC PLATED, 1/2 ID x 1 1/16 OD x 3/32 TH
40	3108-050L-C	LOCKWASHER, 1/2 MEDIUM, PLATED
41	3103-050C1.75B	SOCKET HEAD CAP SCREW, 1/2-13 x 1 3/4, BLACK OXIDE
42	3102-063-18RC	JAM NUT, 5/8-18 RIGHT, CLEAR ZINC
43	1136	TUBE ADAPTER .830 x 5/8-18 LEFT
44	A16.083-020.000	CUT TUBE, 20.000 x <input type="checkbox"/> 1 x .083 WALL 4130

45	2	1506	TUBE ADAPTER .830 x 5/8-18 LEFT
46	2	3102-063-18LY	JAM NUT, 5/8-18 LEFT, YELLOW ZINC
47	2	3136-063X050-LT	ROD END, 5/8- 8 LEFT x 1/2 BORE CMX10-8T-FI
48	4	3108-038H-S	HIGH COLLAR LOCKWASHER, 3/8 STAINLESS
49	4	3103-038C1.00C	SOCKET HEAD CAP SCREW, GRADE 8, 3/8-16 x 1, CLEAR ZINC,
50	4	1000	MISALIGNMENT BUSHING <input type="checkbox"/> 1/2 BORE x .250
51	2	7959-2018	FRAME BRACKET, DRIVER FRONT, FI G-STREET WATTS LINK
52	2	7959-2020	FRAME BRACKET, PSGR FRONT, FI G-STREET WATTS LINK
53	1	7959-2022	GUSSET, WATTS LINK FRAME BRACKET, DRIVER, FI G-STREET
54	1	7959-2024	GUSSET, WATTS LINK FRAME BRACKET, PASSENGER, FI G-STREET
55	1	D26.125-0C1.500	CUT TUBE, <input type="checkbox"/> 1/2 x .125 WALL DOM x 1.500
56	4	3120-050S-Y	FLAT WASHER, 1/2 SAE, HARDENED, YELLOW ZINC
57	2	3100-050F2.50Y	HEX BOLT, 1/2-20 x 2 1/2, GRADE 8, YELLOW ZINC
58	2	3101-050-20C	LOCKNUT, 1/2-20, GRADE 5, NYLON INSERT, CLEAR ZINC
59	1	1477-D	G-BAR STRAIGHT SHOCK MOUNT, DRIVER, ADJUSTABLE, OFFSET
60	8	7955-093-125	SPACER, <input type="checkbox"/> 1/2 BORE x .125 LONG, <input type="checkbox"/> .85 OD x .175 OAL
61	8	3109-038-S-2-Y	AIRCRAFT WASHER 3/8 x .062 THICK
62	4	3100-038F2.00Y	HEX BOLT, 3/8-24 x 2, GRADE 8, YELLOW ZINC
63	4	3101-038-24C	LOCKNUT, 3/8-24, GRADE 5, NYLON INSERT, CLEAR ZINC
64	4	3100-050F2.75Y	HEX BOLT, 1/2-20 x 2 3/4, GRADE 8, YELLOW ZINC
65	4	3101-050-20C	LOCKNUT, 1/2 20, GRADE 5, NYLON INSERT, CLEAR ZINC
66	1	1477-P	G-BAR STRAIGHT SHOCK MOUNT, PSGR, ADJUSTABLE, OFFSET
67	1	E26.134-048.000	STEEL TUBE, ϕ 1 5/8 x .134 ERW x 48.000 LONG
68	4	2101	SUSPENSION TAB 1/2 INCH HOLE
69	1	7959-2025	CROSS TUBE, G-STREET WATTS LINK, FI
70	1	4765-21	ANTI-ROLL BAR TUBE, ϕ 3/4, G-BAR BALL PIVOT, UNIVERSAL
71	2	1162-0.495	BALL END SHAFT ADAPTER, 1 1/4-48 SPLINE x .495
72	2	3701	PRELOAD ADJUSTER ASSEMBLY BALL END ANTIROLL BAR
73	2	1262	LOCKING RING, 1 7/8-20 THREAD 1/2 DRIVE, BALL END ANTIROLL
74	2	3151-038F-C	FENDER WASHER, 3/8 x 1 1/2, ZINC PLATED
75	2	3108-038L-C	LOCK WASHER, HELICAL SPRING <input type="checkbox"/> 3/8, STEEL, ZINC
76	6	3100-038F1.50Y	HEX BOLT, 3/8-24 x 1 1/2, GRADE 8, YELLOW ZINC
77	2	1468	ANTI-ROLL STRAIGHT ARM, 1 1/4-48 SPLINE, 8.20 LONG
78	2	3108-038H-C	HIGH COLLAR LOCKWASHER, 3/8 STEEL, CLEAR ZINC
79	2	3103-038C1.75C	SOCKET HEAD CAP SCREW, GRADE 8, 3/8-16 x 1 3/4, CLEAR ZINC
80	2	3111-038X038-RT	ROD END, 3/8-24 RIGHT x 3/8 BORE, MALE, TEFLON, CM6T
81	2	1086	ADJUSTER, 3.0 x 3/8-24, ANTI-ROLL BAR
82	2	3111-038X038-LT	ROD END, 3/8-24 LEFT x 3/8 BORE, MALE, TEFLON, CML6T
83	2	3102-038-24LY	JAM NUT, 3/8-24 LEFT, YELLOW ZINC
84	4	3101-038-24C	LOCKNUT, 3/8-24, GRADE 5, NYLON INSERT, CLEAR ZINC
85	2	3102-038-24RC	JAM NUT, 3/8-24 RIGHT, CLEAR ZINC
86	4	2121	CLEVIS TAB <input type="checkbox"/> 3/8 HOLE
87	4	3109-038-S-2-Y	AIRCRAFT WASHER 3/8 x .062 THICK

PARTS LIST

Prior to installation use the following parts lists to verify that you have received all components.

Torque Arm Assembly - OPTION *(You will receive one of the options listed.)*

1	300-0188	Torque arm assembly, 45.7" installed length
1	300-0189	Torque arm assembly, 48.8" installed length
1	300-2045	Torque arm assembly, 55.7" installed length

Torque Arm Pinion Support Mount - OPTION *(You will receive one of the options listed.)*

1	300-0190	Ford 9" and Strange ST Iron 9"
1	300-0191	Strange Pro-Aluminum 9"

Torque Arm Pivot Eye - OPTION *(You will receive one of the options listed.)*

1	7959-0157	Poly-bushing torque arm pivot
1	7959-0175	Pivot-ball torque arm pivot

Torque Arm Chassis Crossmember - OPTION

1	5858-U01	Torque arm crossmember, removable (weld-in)
---	----------	---

Lower Suspension Links - OPTION *(You will receive one of the options listed.)*

1	300-2039	20" g-Link tubular steel, 1-1/4" OD, centered pivotball (pair)
1	300-2002	20" g-Link billet aluminum, centered pivotball (pair)
1	300-0102	21" g-Link tubular steel, 1-1/2" OD, centered pivotball (pair)
1	300-0144	21" g-Link tubular steel, 1-1/2" OD, offset pivotball (pair)
1	300-0103	21" g-Link billet aluminum, centered pivotball (pair)
1	300-0122	24" g-Link tubular steel, 1-1/2" OD, centered pivotball (pair)
1	300-0140	24" g-Link tubular steel, 1-1/2" OD, offset pivotball (pair)
1	300-0123	24" g-Link billet aluminum, centered pivotball (pair)
1	300-0141	24" g-Link billet aluminum, offset pivotball (pair)

WITHOUT FAB9 - If your suspension system was ordered without a factory-welded FAB9 housing, the lower control arm axle brackets and fixture will be selected options. If ordered with FAB9 housing brackets will come factory welded to housing.

Additional Components Required (weld-on by installer)

1	6731	Weld fixture for torque arm housing mounting tabs
1	7959-0285	Torque arm serrated housing mount tab, driver side
1	7959-0286	Torque arm serrated housing mount tab, passenger side

Axle Brackets (weld-on lower) - 300-0183

1	7959-0044	Lower axle bracket with anti-roll-bar bosses, driver side, weld-on
1	7959-0045	Lower axle bracket with anti-roll-bar bosses, passenger side, weld-on

Shock Absorber Components *NOTE: You will receive only one of the options listed below.*

1	VAS 11111-515	Coil-over shocks, 5" travel, bearing eyes, single-adjustable (Q1)
1	VAS 11211-515	Coil-over shocks, 5" travel, bearing eyes, double-adjustable (Q2)
1	VAS 11411-50	Coil-over shocks, 5" travel, bearing eyes, 4-way remote reservoir (Q4R)
1	VAS 131K2-515	Air-spring shocks, 5" travel, poly eyes, single-adjustable (Q1)
1	VAS 132K2-515	Air-spring shocks, 5" travel, poly eyes, double-adjustable (Q2)

Components for Coil-Over Shocks

1	VAS 508-105	Spacer set for bearing mount shocks
1	VAS 21-12175	Coil springs, 12" length, 175 lb/in rate
1	VAS 21-12200	Coil springs, 12" length, 200 lb/in rate
1	VAS 21-10200	Coil springs, 10" length, 200 lb/in rate (for Q4R shocks only)
1	VAS 21-10250	Coil springs, 10" length, 250 lb/in rate (for Q4R shocks only)

Upper Shock Crossmember - 6267

4	2101	Mounting tab 1/2" hole
2	3100-050F2.50Y	Bolt 1/2-20 x 2-1/2" hex head, Grade 8, yellow zinc
2	3101-050-20C	Locknut 1/2-20 nylon insert, plated
1	E26.134-048.000	Tube 1-5/8 x .134"-wall

Lower Shock Mounts - 300-0106

1	1477-D	Shock mount, billet aluminum, driver side
1	1477-P	Shock mount, billet aluminum, passenger side
4	3100-038F2.00Y	Bolt, 3/8-24 x 2" hex head Grade 8
2	3100-050F2.75Y	Bolt, 1/2-20 x 2-3/4" hex head Grade 8
4	3101-038-24C	Locknut, 3/8-24 nylon insert
2	3101-050-20C	Locknut, 1/2-20 nylon insert
8	3109-038-S-2-Y	Aircraft washer, 3/8" small OD

Splined-End Anti-Roll Bars - OPTION *(You will receive one set of the options listed.)*

Qty	Part Number	Description
1	300-0172, 300-0194	Assembled bar for 34.3" lower arm width (X10-mini)
1	300-0142, 300-0143	Assembled bar for 35.3" lower arm width (F10-mini)
1	300-0150, 300-0161	Assembled bar for 35.8" lower arm width (F20-mini)
1	300-0137, 300-0137	Assembled bar for 38.3" lower arm width (F10-OEM)
1	300-0115, 300-0116	Assembled bar for 38.8" lower arm width (M10-OEM)
1	300-0149, 300-161	Assembled bar for 40.8" lower arm width (F20-OEM)
1	4765-21, 300-0197	Unassembled bar for 32-43" lower arm width, welding required (U10)

INSTRUCTIONS

- *Individual installation instructions with part lists are provided with each component group. Verify that the components match your selected options.*
- *Specific installation instructions and part lists are provided with each component group.*
- *A general knowledge of metal fabrication, welding and automotive suspension is required.*
- *Mockup and tack weld all components to verify position for correct operation before final welding.*

Prepare Rearend Housing

- *Lower serrated torque-arm housing tabs must be installed using the weld fixture at this time.*
- *The pinion support mount must be installed onto the third-member (longer bolts provided) and the third-member installed into rearend housing before proceeding.*

General Procedure

Suspension and chassis component positions are based off the rearend housings position at intended ride height. Brackets will require trimming to ensure correct alignment. Some cutting and fabrication may be required to complete installation.

Refer to individual installation instructions for specific hardware and procedures.

- *Position the housing centered in relation to the chassis, at intended ride height and correct pinion angle before proceeding. Housing must remain in this position throughout suspension mockup.*
1. *Lower control arms to chassis*
 2. *Axle brackets to housing*
 3. *Torque arm to housing*
 4. *Torque arm chassis crossmember*
 5. *Watts link or panhard bar*
 6. *Shock crossmember*
- *With all part securely tack welded move the suspension through the full range of travel to check for clearance issues. Make adjustments as needed before final welding and completing installation.*

NOTES:

WARRANTY NOTICE:

There are NO WARRANTIES, either expressed or implied. Neither the seller nor manufacturer will be liable for any loss, damage or injury, direct or indirect, arising from the use or inability to determine the appropriate use of any products. Before any attempt at installation, all drawings and/or instruction sheets should be completely reviewed to determine the suitability of the product for its intended use. In this connection, the user assumes all responsibility and risk. We reserve the right to change specification without notice. Further, Chris Alston's Chassisworks, Inc., makes **NO GUARANTEE** in reference to any specific class legality of any component. **ALL PRODUCTS ARE INTENDED FOR RACING AND OFF-ROAD USE AND MAY NOT BE LEGALLY USED ON THE HIGHWAY.** The products offered for sale are true race-car components and, in all cases, require some fabrication skill. **NO PRODUCT OR SERVICE IS DESIGNED OR INTENDED TO PREVENT INJURY OR DEATH.**

Chris Alston's Chassisworks
8661 Younger Creek Drive
Sacramento, CA 95828
Phone: 916-388-0288
Technical Support: sales@cachassisworks.com

