

READ ALL INSTRUCTIONS COMPLETELY AND THOROUGHLY UNDERSTAND THEM BEFORE DOING ANYTHING.
CALL CHASSISWORKS TECH SUPPORT (916) 388-0288 IF YOU NEED ASSISTANCE.

INSTALLATION GUIDE



5907-R4BR

Rear Floor Kit for Canted 4-Link and Torque Arm Suspensions



NOTE: Builder Wheel Tubs must be purchased separately.

Description: Rear floor kit for Canted 4-Link and Torque Arm frame clips and suspension. Contains complete floor behind driveshaft loop crossmember to tail light panel with builder tub extensions and rear firewall between tubs. Builder Wheel Tubs must be purchased separately.

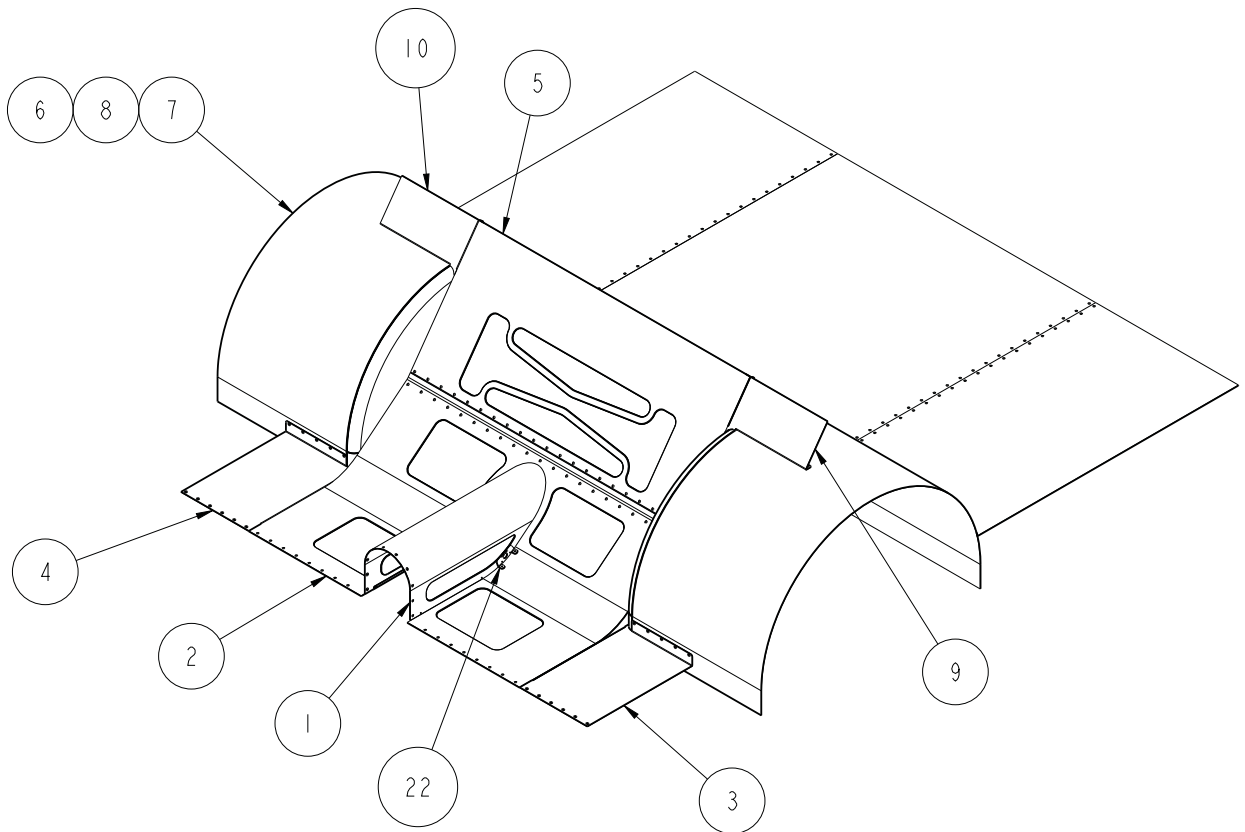
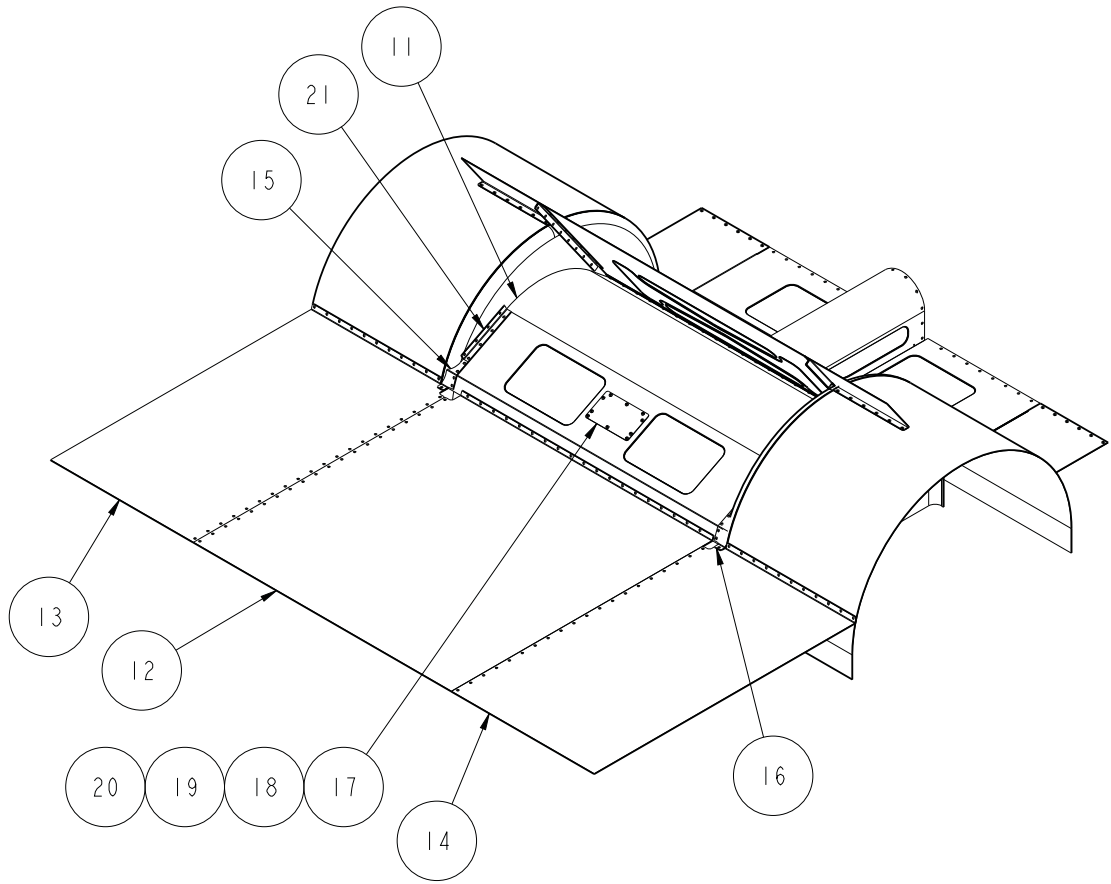

ITEM	QTY	PART NO.	DESCRIPTION
1	1	7972-2554	REAR TUNNEL TERMINATION, gSTREET 2x4 CHASSIS
2	1	7972-2553	REAR FLOOR, AXLE FRONT, gSTREET 2x4 CHASSIS
3	1	7972-2555	REAR FLOOR FILLER, FRONT AXLE, OUTBOARD DRV, gSTREET 2x4 CHASSIS
4	1	7972-2556	REAR FLOOR FILLER, FRONT AXLE, OUTBOARD PSGR, gSTREET 2x4 CHASSIS
5	1	7972-2557	BULKHEAD, REAR FIREWALL, gSTREET 2x4 CHASSIS
6	2	7972-2187	Ø34 WHEEL TUB CAP
7	2	7972-2191	SKIN, WHEEL TUB, Ø34 x 60 LONG, 3.30 STRAIGHT, 20 WIDE
8	2	7972-2193	INSERT, WHEEL TUB CORNER
9	1	7972-2359	FILLER PLATE, REAR FIREWALL, DRIVER, gSTREET 2x4 CHASSIS
10	1	7972-2360	FILLER PLATE, REAR FIREWALL, PSGR, gSTREET 2x4 CHASSIS
11	1	7972-2559	REAR FLOOR, OVER AXLE, gSTREET 2x4 CHASSIS
12	1	7972-2560	TRUNK FLOOR, CENTER, gSTREET 2x4 CHASSIS
13	1	7972-2567	TRUNK FLOOR, DRIVER, gSTREET 2x4 CHASSIS
14	1	7972-2568	TRUNK FLOOR, PASSENGER, gSTREET 2x4 CHASSIS
15	1	7972-2569	CORNER FILL, WHEEL TUB, DRV, gSTREET 2x4 CHASSIS
16	1	7972-2570	CORNER FILL, WHEEL TUB, PSGR, gSTREET 2x4 CHASSIS
17	1	7972-2550	COVER, RESERVOIR POCKET, CANTED 4-BAR, 27 DEGREE
18	10	3104-019F0.50S	BUTTON HEAD SOCKET CAP SCREW 10-32 x 1/2, STAINLESS STEEL
19	10	3157-019S-S	WASHER, #10 SAE, STAINLESS, 7/32 ID x .7/16 OD x 3/64 THICK
20	10	3101-019-32S	LOCKNUT 10-32, GRADE 5, STAINLESS STEEL
21	1	7972-2558	FORMED ANGLE, 3/4 x 18 GA, 48 LONG
22	2	7972-2380	ALIGNMENT TOOL, FLOOR TO TUNNEL, IRS

DESCRIPTION		REAR FLOOR KIT, gSTREET, 2x4 CHASSIS, 34 TO 42 WIDE	
<i>Chris Alston's</i> CHASSISWORKS INC. 8661 YOUNGER CREEK DRIVE SACRAMENTO, CA 95828 (916) 388-0288 FAX 388-0295		PART NO.	5907-R4BR
		5/17/18	DWG: 7951-5907R4BR

PARTS LIST

5907-R4BR.12 - Rear Floor Kit (Box 1 of 2)

Qty	Part Number	Description
10	3101-019-32X	Locknut, 10-32, stainless
10	3104-019F0.50S	Cap screw, 10-32 x 1/2" button head, stainless
10	3157-019S-S	Washer, #10 flat, stainless
1	5907-EXT	Wheel tub extension, 7" length (pair)
1	7972-2359	Rear firewall filler plate, driver side
1	7972-2360	Rear firewall filler plate, passenger side
2	7972-2380	Floor alignment tool, IRS clip
1	7972-2550	Reservoir pocket cover, 27-degree
1	7972-2553	Rear floor forward of axle
1	7972-2554	Rear tunnel termination
1	7972-2555	Front outboard floor filler, driver side
1	7972-2556	Front outboard floor filler, passengerside
1	7972-2557	Rear firewall bulkhead
1	7972-2558	Formed angle, 3/4"
1	7972-2559	Rear floor over axle
1	7972-2569	Wheel tub corner fill, driver side
1	7972-2570	Wheel tub corner fill, passenger side

5907-R4BR.22 - Rear Floor Kit (Box 2 of 2)

Qty	Part Number	Description
1	7972-2560	Trunk floor, center
1	7972-2567	Trunk floor, driver side
1	7972-2568	Trunk floor, passenger side

INSTRUCTIONS

Cleco Assembly Tabs

Cleco fasteners and pliers make fitting sheet metal pieces together for welding much easier and are highly recommended. Clecos are small, spring-loaded clamps that insert into 1/8" holes to draw multiple panels together. A twenty-five fastener and plier set is available from Chassisworks; Item 6702.

Assembly tabs are included with the transmission tunnel to aid in fitting the tunnel to the floor and firewall. Tabs should be bent, clecoed or tacked as needed.



FITMENT

- Floor and firewall pieces are pre-formed for accurate fit, aligning from the driveshaft tunnel outward.
- Begin by aligning the driveshaft tunnel and adjoining floor section with the forward edge of the B-pillar crossmember and driveshaft loop. The floor section must be trimmed flush with outside edge of the frame.
- Outer floor sections forward of the axle are fit and trimmed to meet the rocker after the wheel tubs have been installed.
- Rear firewall panel must be trimmed flush with the outside edge of the frame. Top edge is bent and trimmed as required to meet the rear deck.
- Outside firewall filler plates are trimmed and fit after the wheel tubs have been installed.
- The over the axle panel is also trimmed flush to the outside of the frame rail and is positioned to meet the firewall panel.
- Center trunk floor can be fit at trimmed along the tail light panel at this time.
- Outside trunk floor panels are fit and trimmed after wheel tubs have been installed.

WELDING

- Use of a heatsink will drastically reduce warpage when welding. A large chunk of aluminum clamped by the welding area makes a simple but effective heatsink. Tack welding every 1/2 to 3/4 of an inch before final welding will also help.

WARRANTY NOTICE:

There are NO WARRANTIES, either expressed or implied. Neither the seller nor manufacturer will be liable for any loss, damage or injury, direct or indirect, arising from the use or inability to determine the appropriate use of any products. Before any attempt at installation, all drawings and/or instruction sheets should be completely reviewed to determine the suitability of the product for its intended use. In this connection, the user assumes all responsibility and risk. We reserve the right to change specification without notice. Further, Chris Alston's Chassisworks, Inc., makes **NO GUARANTEE** in reference to any specific class legality of any component. **ALL PRODUCTS ARE INTENDED FOR RACING AND OFF-ROAD USE AND MAY NOT BE LEGALLY USED ON THE HIGHWAY.** The products offered for sale are true race-car components and, in all cases, require some fabrication skill. **NO PRODUCT OR SERVICE IS DESIGNED OR INTENDED TO PREVENT INJURY OR DEATH.**

Chris Alston's Chassisworks
8661 Younger Creek Drive
Sacramento, CA 95828
Phone: 916-388-0288
Technical Support: sales@cachassisworks.com

